

omporro 

officine meccaniche porro



ENRICO CASSINA

MANUFACTURED BY OFFICINE MECCANICHE PORRO

MANIGLIERIA DI PREGIO DAL 1850

ARTIGIANI DELL'ECCELLENZA

Nel 1946, dal laboratorio di Alfredo Porro, nasce Officine Meccaniche Porro e quello che era un laboratorio artigiano acquista le dimensioni di un'Azienda senza mai perdere la sua vocazione artigianale.

Negli anni '70 sarà il figlio Giuseppe, ad allargare la gamma di prodotti di grande qualità concepiti e creati con passione, esteticamente pregevoli e tecnologicamente sempre all'avanguardia.

Tutti valori che sono passati anche alla terza generazione della famiglia: Fabio, Donata e Paola che continuano ad offrire una produzione in cui qualità, passione artigianale, estetica e la miglior tecnologia disponibile ben rappresentano l'Eccellenza Italiana in oltre 80 Paesi nel mondo.

EXCELLENCE IN CRAFTSMANSHIP

In 1946, Alfredo Porro transformed his workshop into Officine Meccaniche Porro, effectively turning a craft laboratory into a corporate endeavor that, however, never lost its artisanal roots.

In the 1970s, Alfredo's son, Giuseppe, broadened the range of high-quality, aesthetically valuable and technologically advanced products designed and created with passion.

These values have been passed on to the Porro Family's third generation: Fabio, Donata and Paola continue to offer today products whose quality, artisanal passion, aesthetics and state-of-the-art technology well represent Italian Excellence in more than 80 countries.

ENRICO CASSINA

MANUFACTURED BY OFFICINE MECCANICHE PORRO

MANIGLIERIA DI PREGIO DAL 1850

Il prestigioso marchio Enrico Cassina rappresenta l'apice della qualità e dello stile nella manigliera.

Veri «pezzi d'arte» artigianali nella purezza stilistica che va dal Barocco al Contemporaneo e che consente di completare coerentemente qualsiasi progetto architettonico o di interior design.

Prodotti unici e ricercati presenti nelle ville e negli hotel più prestigiosi in oltre 80 Paesi nel mondo e che, come tutta la produzione Officine Meccaniche Porro, sono garantiti 100% Made in Italy.

PRESTIGIOUS DOOR HANDLES SINCE 1850

The prestigious Enrico Cassina brand represents the pinnacle of quality and style in door handles. True artisanal "art pieces" whose style ranges from the Baroque to Contemporary themes, and allows completing any architectural or interior design project. Unique and sophisticated products installed in the most prestigious villas and hotels in more than 80 countries, and which, like all Officine Meccaniche Porro production, are guaranteed, 100% Made-in-Italy creations.

ALFREDO PORRO

MANUFACTURED BY OFFICINE MECCANICHE PORRO

COMPLEMENTI D'ARREDO IN METALLO NOBILE

Il marchio, dedicato al nostro fondatore, contraddistingue la nostra produzione di complementi per mobili, tende e scale in cui la qualità delle materie prime, la funzionalità e l'aspetto decorativo raggiungono livelli estremamente elevati.

Oggetti curati nel dettaglio, solidi e destinati a durare nel tempo e un gran numero di referenze, di stili, di materiali e di finiture che possono soddisfare ogni esigenza e completare, coerentemente, la nostra offerta di maniglie.

NOBLE METAL ACCESSORIES

Our brand, dedicated to our founder, defines our production of accessories for furniture, curtains and stairs whose raw material quality, functionality and decorative aspect reach extremely high levels. Solid, durable and carefully detailed items, as well as a large number of references, styles, materials and finishes that can meet any expectation and complete our range of handles.



IL PERFETTO
INCONTRO
TRA INDUSTRIA
E DESIGN

THE PERFECT
MATCH BETWEEN
MANUFACTURING
AND DESIGN

Fino alla metà dell'Ottocento le belle maniglie erano prerogativa di palazzi nobiliari o ricche dimore; è *Enrico Cassina*, a metà del secolo, ad intuire l'esigenza diffusa di disporre di *maniglie esteticamente pregevoli*.

Inizia così la sua produzione che, grazie a stampi opportunamente creati, può riproporre *maniglie di pregio* a costi più abbordabili, maniglie d'arte e di stile che, oggi, coprono un arco temporale dal *Barocco* al *Contemporaneo*.

È nel 2005 che *Officine Meccaniche Porro* rileva lo storico marchio *Enrico Cassina* avendo così accesso all'*ampio archivio di stampi* che costituisce «un tesoro» per chi ancora produce con passione e molta artigianalità.

Con un certosino lavoro di catalogazione Officine Meccaniche Porro ha reso utilizzabile questo storico archivio che - integrato da rivisitazioni e creazioni contemporanee - consente di disporre di una scelta di *maniglie stilisticamente coerenti a tutte le epoche* ed a tutti gli *stili architettonici*.

Splendide maniglie con un *vantaggio di scelta unico e incomparabile* di cui non esistono uguali sul mercato.

Materie prime nobili e *tecnologie meccaniche avanzate*, unite a *finiture artigianali* e manuali, come solo le botteghe artigiane sanno ancora fare, contraddistinguono la produzione Enrico Cassina.

Le maniglie e gli accessori per porta del marchio Enrico Cassina rappresentano, oggi, il perfetto connubio tra *arte, artigianalità e tecnologia*, tutto rigorosamente *100% Made in Italy*.

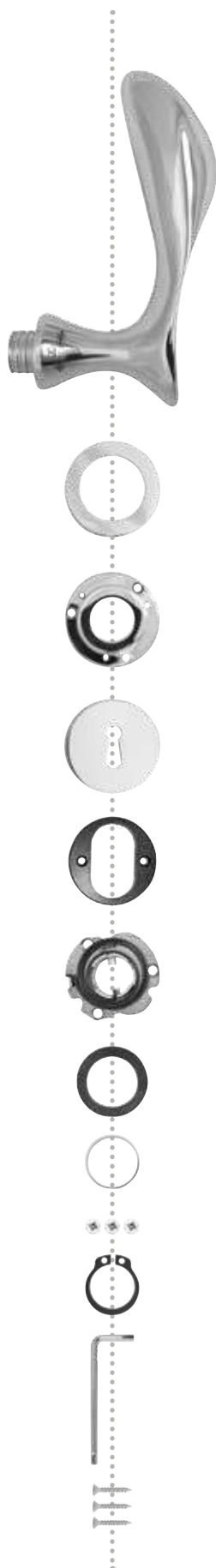

Until the middle of the nineteenth century, beautiful door handles only belonged in noble palaces or stately homes; by then, *Enrico Cassina* well understood the increasing need to produce *aesthetically pleasant handles*.

That is how he began reproducing *exquisite door handles*, which, thanks to the use of casts, were more affordable. Over time, the styles offered covered a broad temporal arch, stretching from the *Baroque* to more *Contemporary periods*.

Officine Meccaniche Porro acquired the renowned *Enrico Cassina brand* in 2005, thus gaining access to a *rich inventory of molds* that are nothing short of a treasure for a manufacturer that still produces with passion and craftsmanship.

After painstaking cataloging, Officine Meccaniche Porro has made this inventory accessible for use, also enriching it with contemporary creations and adaptations. This precious repertoire inspires the production of *handles that are stylistically consistent with the reference epoch* and all offered *architectural styles*.

They are exquisite products that can be chosen from an *incomparable range* with no rivals on the market.

The Enrico Cassina handles marry *noble raw materials* and *mechanically advanced technology* to precious *manual finishes*, just like artisan workshops can do.

Enrico Cassina door handles and accessories represent today the perfect marriage among *100% Made-in-Italy art, craftsmanship and technology*.

QUANDO
LO STILE
DIVENTA
ARTE



WHEN
STYLE
BECOMES
ART



Le maniglie *Enrico Cassina* sono **pezzi d'arte** che racchiudono, con estrema maestria, lo **stile dell'epoca** che rappresentano e l'abilità artigianale che porta a particolari finissimi e **finiture manuali di alto valore**, maniglie uniche sul mercato.

La loro realizzazione è resa possibile grazie alle **Officine Meccaniche Porro** che mantiene in essere un **sistema produttivo** altrettanto unico: non «in linea» ma composto da più **botteghe artigianali** che lavorano in sinergia tra loro.

Questa organizzazione del lavoro permette di curare con passione artigianale ogni singola maniglia a cui si applicano i migliori meccanismi disponibili, molti brevettati ed unici sul mercato, per farne oggetti oltre che **stilisticamente perfetti meccanicamente all'avanguardia**.

La produzione di maniglie Enrico Cassina si fonda su una storia di **ricerca stilistica**, lunga 150 anni, che va dal Barocco al Contemporaneo, permettendo ad Architetti ed Interior Designer, così come ai **Clienti più esigenti**, di disporre di maniglie coerenti con il proprio progetto o con la propria **abitazione di prestigio**.

Ogni maniglia Enrico Cassina, prodotta solo con **materie prime di elevatissima qualità**, viene **manualmente rifinita** da esperti artigiani che con passione producono veri e propri pezzi d'arte, unici e 100% Made in Italy.

The *Enrico Cassina handles* are **unique works of art** that embody, with great mastery, **the style of the times** they represent, as well as the craftsmanship that ensures great attention to detail and **highly valuable manual finishes**.

Their production is made possible by **Officine Meccaniche Porro** and its unique **manufacture system**, one that is not linear, but comprising a series of **artisan workshops** that operate in synergy with one another.

This work organization allows producing every single handle with utmost attention and the use of mechanisms, many of which are patented and thus unique on the market, that enable the creation of **stylistically and mechanically perfect objects**.

The production of Enrico Cassina handles leverages a more than 150-year long **search for style** encompassing art periods stretching from the Baroque to the Contemporary age, thus allowing Architects and Interior Designers, as well as the **most demanding customers**, to have handles that meet their specifications or are perfect complement of their **elegant homes**.

Every Enrico Cassina handle, produced only with **raw materials of the highest quality**, is **manually finished** by skilled craftsmen who passionately produce real pieces of unique and 100% Made-in-Italy art.

LA PUREZZA DELLO STILE DAL BAROCCO AL CONTEMPORANEO



Fare una maniglia «in stile» è un esercizio che riesce a molti, fare delle maniglie rispettando la *purezza dello stile* riesce solo ad *Enrico Cassina*.

Non solo perché Enrico Cassina può contare su un archivio di stampe storico e ineguagliabile, ma anche perché la «purezza dello stile» si coglie nei *particolari più minuti* che richiedono, oggi come 150 anni fa, *l'intervento manuale* di *esperti artigiani* che Officine Meccaniche Porro è in grado di garantire.

PURITY OF STYLE FROM BAROQUE TO CONTEMPORARY THEMES

BAROCCO ITALIANO
ITALIAN BAROQUE



LUIGI XV
LOUIS XV



LUIGI XVI
LOUIS XVI

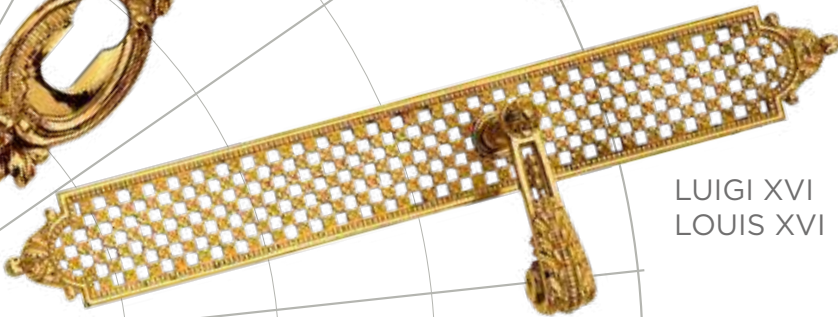

PRIMO IMPERO
FIRST EMPIRE



SECONDO IMPERO
SECOND EMPIRE



COLONIALE
COLONIAL

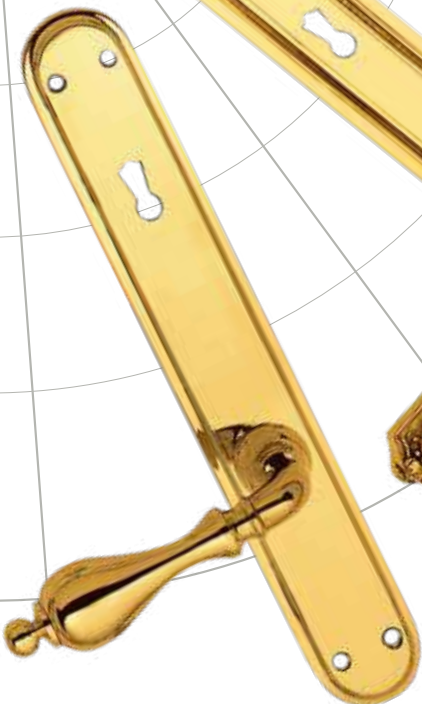

Many can make a stylish handle; making handles that respect *purity of style* is, however, something that only *Enrico Cassina* can do.

Not only because Enrico Cassina can count on a rich and unrivalled inventory of historical and unique molds, but also because “purity of style” is achieved through the *smallest details* that, today like 150 years ago, require *experienced craftsmen* that only Officine Meccaniche Porro can provide.

INDICE

MODERNO/MODERN

ART NOUVEAU pag 12



NOVECENTO/XX CENTURY pag 18



ART DÉCO pag 52



TRENTA/THIRTIES pag 58



CINQUANTA/FIFTIES pag 80



INEDITA

..... pag 98



THE KNURLED COLLECTION

..... pag 108



ROCOCO POP

..... pag 110



CLASSICO/CLASSIC

BAROCCO ITALIANO/ITALIAN BAROQUE pag 114



LUIGI XV/LOUIS XV pag 128



INDEX

LUIGI XVI/LOUIS XVI pag 138



PRIMO IMPERO/FIRST EMPIRE pag 146

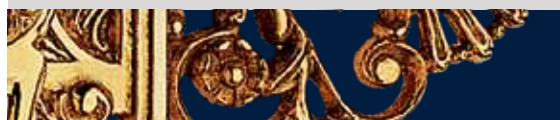

SECONDO IMPERO/SECOND EMPIRE pag 168



COLONIALE/COLONIAL pag 178



MATERIE PREZIOSE/PRECIOUS MATERIALS

MOSAICO/MOSAIC pag 192

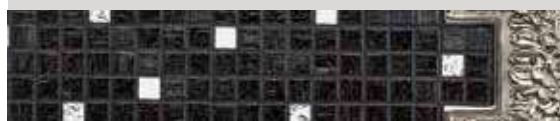

MADREPERLA/MOTHER OF PEARL pag 196



ÉLITE COLLECTION

..... pag 200



PERSONALIZZAZIONI/BESPOKE SERVICE

..... pag 220

ACCESSORI PORTA/DOOR ACCESSORIES

..... pag 222



INDICE

CODICE CODE	PAGINA PAGE	NOME NAME	COLLEZIONE COLLECTION
716	160	Ortensia	Primo Impero/First Empire
722	164	Carlotta	Primo Impero/First Empire
3000	74	Ada	Trenta/Thirties
4800	184	Emanuela	Coloniale/Colonial
4801	76	Anja	Trenta/Thirties
4802	28	Susanne	Novecento/XX Century
4803	90	Kazuyo	Cinquanta/Fifties
4806	186	Indira	Coloniale/Colonial
4807	92	Odile	Cinquanta/Fifties
4809	20	Eileen	Novecento/XX Century
A001	190	Everest	Élite Collection
A002	192	Sahara	Élite Collection
A003	194	Uluru	Élite Collection
A004	196	Vulcano	Élite Collection
A005	198	Caraibi	Élite Collection
A006	200	Amazzonia	Élite Collection
A007	202	Blue Hole	Élite Collection
A008	204	Columbia	Élite Collection
A009	206	Andros	Élite Collection
A004	110	Winter	Inedita
A006	102	Upper	Inedita
C007	170	Eleonore	Secondo Impero/Second Empire
A008	104	Vasilij	Inedita
A009	106	Leontia	Inedita
C012	120	Elisabetta	Barocco Italiano/Italian Baroque
C016	138	Marie-Antoinette	Luigi XVI/Louis XVI
C018	140	Gabrielle	Luigi XVI/Louis XVI
C019	118	Artemisia	Barocco Italiano/Italian Baroque
C020	154	Letizia	Primo Impero/First Empire
C024	64	Marisa	Trenta/Thirties
C029	58	Maya	Trenta/Thirties
C030	200	Madreperla	Madreperla/Mother of Pearl
C043	122	Barbara	Barocco Italiano/Italian Baroque
C044	66	Elena	Trenta/Thirties
C050	152	Paolina	Primo Impero/First Empire
C051	142	Sofia	Luigi XVI/Louis XVI
C054	62	Dorotea	Trenta/Thirties
C066	80	Wijdan	Cinquanta/Fifties
C067	134	Adelaide	Luigi XV/Louis XV
C068	84	Gae	Cinquanta/Fifties
C069	82	Anna	Cinquanta/Fifties

INDEX

CODICE CODE	PAGINA PAGE	NOME NAME	COLLEZIONE COLLECTION
C070	86	Afra	Cinquanta/Fifties
C078	34	Niky	Novecento/XX Century
C079	88	Huang	Cinquanta/Fifties
C082	68	Carla-Maria	Trenta/Thirties
C083	158	Stefania	Primo Impero/First Empire
C087	168	Eugenie	Secondo Impero/Second Empire
C090	156	Carolina	Primo Impero/First Empire
C091	132	Du Barry	Luigi XV/Louis XV
C092	70	Elvira	Trenta/Thirties
C093	72	Topazia	Trenta/Thirties
C094	12	Franca	Art Nouveau
C095	54	Annelise	Art Déco
C096	14	Tamara	Art Nouveau
C099	36	Lina	Novecento/XX Century
C101	24	Jeanne	Novecento/XX Century
C110	150	Elisa	Primo Impero/First Empire
C119	130	Pompadour	Luigi XV/Louis XV
C120	114	Lavinia	Barocco Italiano/Italian Baroque
C121	178	Vittoria	Coloniale/Colonial
C122	174	Virginia	Secondo Impero/Second Empire
C12510	148	Marie-Louise	Primo Impero/First Empire
C12512	146	Giuseppina	Primo Impero/First Empire
C126	38	Liisi	Novecento/XX Century
C127	182	Menen	Coloniale/Colonial
C128	128	Marie	Luigi XV/Louis XV
C128 POP	106	Rococòpop	Rococòpop
C130	18	Margherita	Novecento/XX Century
C135	172	Matilde	Secondo Impero/Second Empire
C138	44	Melanie	Novecento/XX Century
C140	180	Clementina	Coloniale/Colonial
C142	48	Aleksandra	Novecento/XX Century
C151	32	Signe	Novecento/XX Century
C162	46	Dora	Novecento/XX Century
C173	30	Lilly	Novecento/XX Century
C178	52	Marianne	Art Déco
C192	42	Jing	Novecento/XX Century
C193	40	Marion	Novecento/XX Century
C471/2/3	196	Mosaico	Mosaico/Mosaic



ART
NOUVEAU

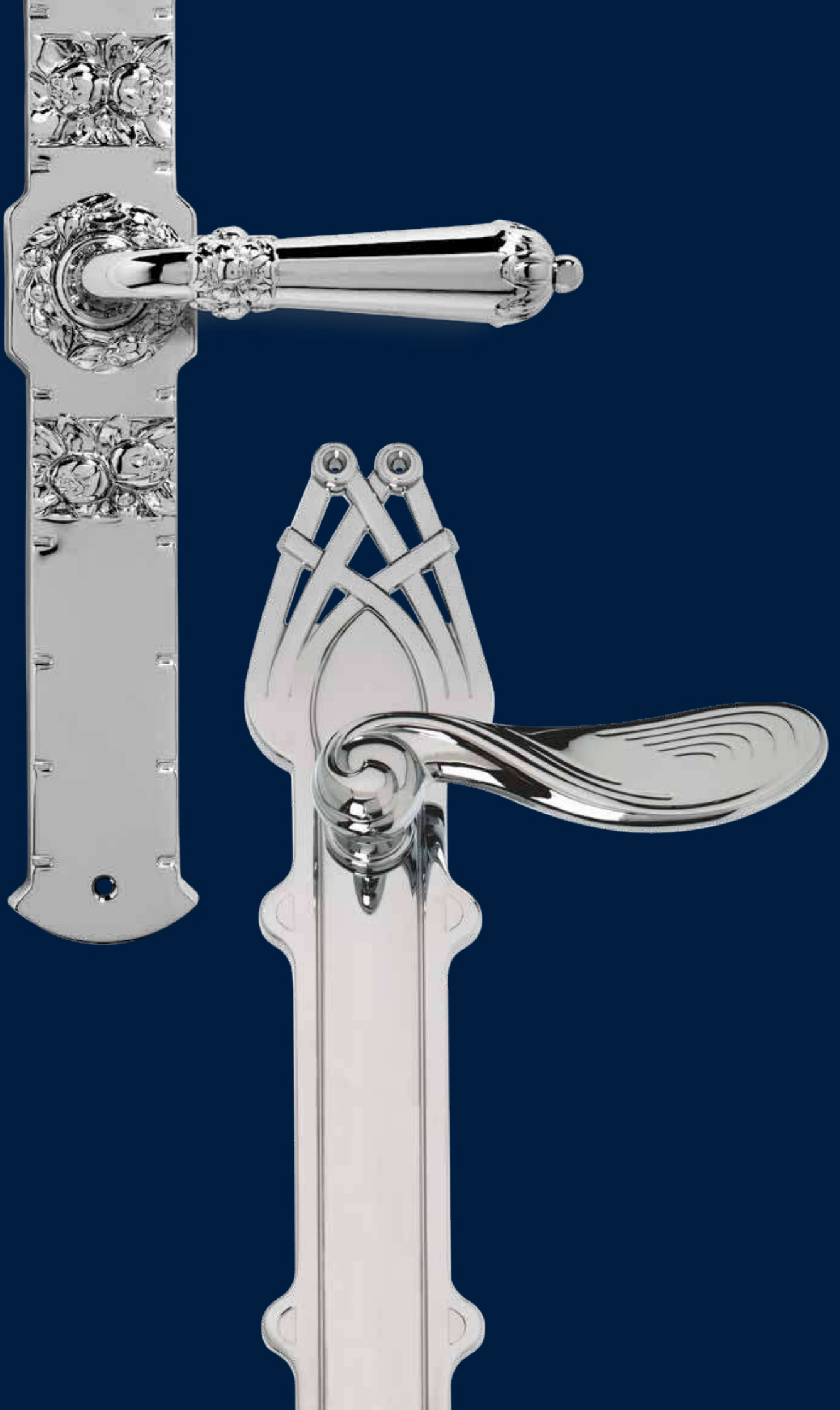

ART NOUVEAU

FRANCA

C09410



Mod. FRANCA

C09410

Designed by ENRICO CASSINA



C09410
141x325

Privacy
C09410/5
141x325



C09411
131x84



C09411/5
131x84



C54500
75x34



C09411 DK
30x141



C09420
45x195



C29400
48x118

Disponibile
versione
girevole **C29400 Q**
(abbinabile con
bocchetta **CB1384**)
Revolving version
available **C29400 Q**
(matching escutcheon
article **CB1384**)



C09450
48x333

ART NOUVEAU

TAMARA

C09610



Mod. TAMARA

C09610

Designed by ENRICO CASSINA



C09610
132x250

Privacy
C09610/5
132x250



C09611
133x50



C09611/5
133x50



C54900
88x30



C09620
38x160



C09611 DK
30x141



C09650
48x360



NOVECENTO

XX CENTURY



NOVECENTO/XX CENTURY

MARGHERITA

C13010



Mod. MARGHERITA

C13010

Designed by ENRICO CASSINA



C13010
133x247

Privacy
C13010/5
133x247



C13011
136x45



C13011/5
136x45

Con la rosetta Ø45mm non è possibile utilizzare la molla e il foro cilindro. With the 45mmØ rose the spring and the yale keyhole can not be used.



C54500
75x34



C13070
44x242



C13020
38x145



C13011 DK
30x146



C13050
45x275

NOVECENTO/XX CENTURY

EILEEN

4809



Mod. EILEEN

4809

Designed by ENRICO CASSINA



480901
139x223

Privacy
480901/5
139x223



480990
145x50



480990/5
145x50



C54500
75x34



4809 DK
30x152

Mod. EILEEN

4809

Designed by ENRICO CASSINA

ENTRANCE SET

.....



830057_AC
830000
70x503
155x340



830157_AC
830100
70x495
155x340



831057_AC
831000
70x503
70x340



831157_AC
831100
70x495
70x340

Mod. EILEEN

4809

Designed by ENRICO CASSINA

INTERIOR SET



480992

153x66

CPR - Privacy
CPA - Passage
CDU - Dummy



485392

Ø66

CPR - Privacy
CPA - Passage
CDU - Dummy

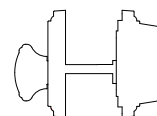

8300DR

Ø66

SC - Single Cylinder
DC - Double Cylinder

INSIDE SET

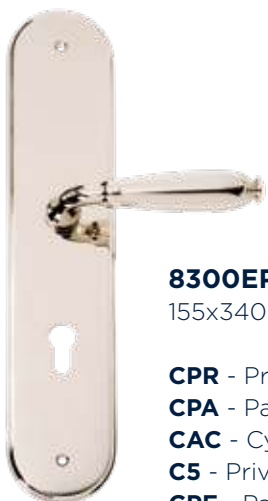

8300EP

155x340

CPR - Privacy
CPA - Passage
CAC - Cylinder
C5 - Privacy EUROPEAN
CPE - Passage EUROPEAN
C2 - Cylinder EUROPEAN



8310EP

70x340

CPR - Privacy
CPA - Passage
CAC - Cylinder
C5 - Privacy EUROPEAN
CPE - Passage EUROPEAN
C2 - Cylinder EUROPEAN

MULTIPOINT



480920

140x240

C25 - Double Cylinder
C05 - Passage
C26 - Patio

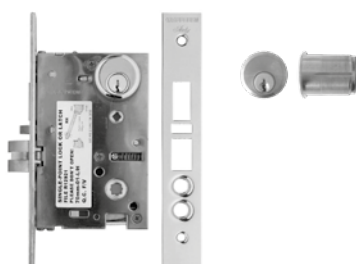

C400S

29
32
35
38

Disponibile serratura
Mortise lock available

NOVECENTO/XX CENTURY

JEANNE

C10110



Mod. JEANNE

C10110

Designed by ENRICO CASSINA



C10110
130x238
C10116
149x238

Privacy
C10110/5
130x238
C10116/5
149x238



C10111
137x58
C10117
156x58



C10111/5
137x58
C10117/5
156x58



C54300
86x33



C10170
50x229



C10120
38x158



C10110 DK
39x148



C10150
58x272

Mod. JEANNE

C10110

Designed by ENRICO CASSINA

ENTRANCE SET



C32100

**Asta C319AS non inclusa
nella confezione**

Rod C319AS is not
included in the package

C30500

- 25** (Asta/Rod L 250 mm)
- 30** (Asta/Rod L 300 mm)
- 35** (Asta/Rod L 350 mm)
- 40** (Asta/Rod L 400 mm)



C41000_AC

70x523
70x143



C41000_00

70x523
70x143



C20100

58x58xh64

Disponibile
versione
girevole **C20100 Q**
(abbinabile con
bocchetta **CB1558**)
Revolving version
available **C20100 Q**
(matching escutcheon
article **CB1558**)



NOVECENTO/XX CENTURY

SUSANNE

4802



Mod. SUSANNE

4802

Designed by ENRICO CASSINA



480291
126x50



480291/5
126x50



C54300
86x33



4802 DK
30x133

NOVECENTO/XX CENTURY

LILLY

C17310



Mod. LILLY

C17310

Designed by ENRICO CASSINA



C17310
126x246

Privacy
C17310/5
126x246



C17311
129x45



C17311/5
129x45

Con la rosetta Ø45mm non è possibile utilizzare la molla e il foro cilindro. With the 45mmØ rose the spring and the yale keyhole can not be used.



C54500
75x34



C17370
44x265



C17320
38x145



C17311 DK
30x139



C17350
45x251

NOVECENTO/XX CENTURY

SIGNE

C15110



Mod. SIGNE

C15110

Designed by ENRICO CASSINA



C15110
142x224

Privacy
C15110/5
142x224



C15170
44x267



C15120
39x153



C15111 DK
30x155



C15111
145x45



C15111/5
145x45



Con la rosetta Ø45mm non è possibile utilizzare la molla e il foro cilindro.

With the 45mmØ rose the spring and the yale keyhole can not be used.



C54500
75x34



CB1968
Ø68



C48800
400 (68x513)
600 (68x713)
800 (68x913)

NOVECENTO/XX CENTURY

NIKY

C07810



Mod. NIKY

C07810

Designed by ENRICO CASSINA



C07810
120x247

Privacy
C07810/5
120x247



C07811
122x45



C07811/5
122x45

Con la rosetta Ø45mm non è possibile utilizzare la molla e il foro cilindro.

With the 45mmØ rose the spring and the yale keyhole can not be used.



C54500
75x34



C07820
39x152



C07811 DK
30x133

NOVECENTO/XX CENTURY

LINA

C09910



Mod. LINA

C09910

Designed by ENRICO CASSINA



C09910
120x244

Privacy
C09910/5
120x244



C09911
120x45



C09911/5
120x45

Con la rosetta Ø45mm non è possibile utilizzare la molla e il foro cilindro.



With the 45mmØ rose the spring and the yale keyhole can not be used.



C54500
75x34



C09920
36x158



C09911 DK
30x133



C09950
237x45

NOVECENTO/XX CENTURY

LIISI

C12610



Mod. LIISI

C12610

Designed by ENRICO CASSINA



C12610

141x246

C12614

161x246

Privacy

C12610/5

141x246

C12614/5

161x246



C12611

146x50

C12615

166x50



C12611/5

146x50

C12615/5

166x50



C54400

81x28



C12620

38x144



C12611 DK

30x153

NOVECENTO/XX CENTURY

MARION

C19310



Mod. MARION

C19310

Designed by ENRICO CASSINA



C19310
130x247

Privacy
C19310/5
130x247



C19311
136x50



C19311/5
136x50



C54400
81x28



C19311 DK
30x143

NOVECENTO/XX CENTURY

JING

C19211



Mod. JING

C19210

Designed by ENRICO CASSINA



C19211
122x50



C19211/5
122x50



C19210
116x247

Privacy
C19210/5
116x247



C54400
81x28



C19211 DK
30x129

NOVECENTO/XX CENTURY

MELANIE

C13810



Mod. MELANIE

C13810

Designed by ENRICO CASSINA



C13810
140x246

Privacy
C13810/5
140x246



C13811
143x45



C13811/5
143x45

Con la rosetta Ø45mm non è possibile utilizzare la molla e il foro cilindro.

With the 45mmØ rose the spring and the yale keyhole can not be used.



C55000
94x33



C13820
38x145



C13811 DK
30x153



C13850
45x209

NOVECENTO/XX CENTURY

DORA

C16210



Mod. DORA

C16210

Designed by ENRICO CASSINA



C16210
122x247

Privacy
C16210/5
122x247



C16211
124x45



C16211/5
124x45

Con la rosetta Ø45mm non è possibile utilizzare la molla e il foro cilindro.



With the 45mmØ rose the spring and the yale keyhole can not be used.



C54400
81x28



C16220
39x152



C16211 DK
30x134



C16250
45x237

NOVECENTO/XX CENTURY

ALEKSANDRA

C14210



Mod. ALEKSANDRA

C14210

Designed by ENRICO CASSINA



C14210
118x247

Privacy
C14210/5
118x247



C14211
121x45



C14211/5
121x45

Con la rosetta Ø45mm non è possibile utilizzare la molla e il foro cilindrico.

With the 45mmØ rose the spring and the yale keyhole can not be used.



C54400
81x28



C14220
39x152



C14211 DK
30x131



ART
DÉCO



ART DÉCO

MARIANNE

C17810



Mod. MARIANNE

C17810

Designed by ENRICO CASSINA



C17810
124x290

Privacy
C17810/5
124x290



C17811
124x60



C17811/5
124x60



C55100
75x28



C17820
45x160



C17810DK
39x139



C27800
60x60xh55

Disponibile
versione
girevole **C27800 Q**
(abbinabile con
bocchetta **CB1860**)
Revolving version
available **C27800 Q**
(matching escutcheon
article **CB1860**)



C47800
400 (45x520)
600 (45x720)
800 (45x920)

ART DÉCO

ANNELISE

C09510



Mod. ANNELISE

C09510

Designed by ENRICO CASSINA



C09510
133x240

Privacy
C09510/5
133x240



C09511
132x89



C09511/5
132x89



C55100
75x28



C09520
38x195



C09511 DK
30x145



C29500
50x50xh65

Disponibile
versione
girevole **C29500 Q**
(abbinabile con
bocchetta **CB2150**)
Revolving version
available **C29500 Q**
(matching escutcheon
article **CB2150**)



C09550
38x368



TRENTA

THIRTIES



TRENTA/THIRTIES

MAYA

C02910



Mod. **MAYA**
C02910
Designed by ENRICO CASSINA



C02910
124x232

Privacy
C02910/5
124x232



C02911
130x50



C02911/5
130x50



C55100
75x28



C02920
39x152



C02910 DK
39x181



C02950
23x290

Mod. **MAYA**
C02910

Designed by ENRICO CASSINA



C32200
**Asta C319AS non inclusa
nella confezione**
Rod C319AS is not
included in the package



C02970
44x280



C23100
50x50xh59

Disponibile
versione
girevole **C23100 Q**
(abbinabile con
bocchetta **CB3350**)
Revolving version
available **C23100 Q**
(matching escutcheon
article **CB3350**)



much
believe
her
tural
me
ms
imals
ants
see

plants
intermediate
certain
organic
nightly
offant
select
case
facts
nature
NOW
birds

TRENTA/THIRTIES

DOROTEA

C05411



Mod. DOROTEA

C05410

Designed by ENRICO CASSINA



C05410
129x232

Privacy
C05410/5
129x232



C05411
134x50



C05411/5
134x50



C55100
75x28



C05450
250 (28x271)



C05470
44x228



C05420
39x152



C05410 DK
39x186



C32300
**Asta C319AS non inclusa
nella confezione**
Rod C319AS is not
included in the package

TRENTA/THIRTIES

MARISA

C02411



Mod. MARISA

C02411

Designed by ENRICO CASSINA



C02411
133x50



C02411/5
133x50



C02470
44x256



C55100
75x28



C02420
39x145



C02411 DK
30x141

TRENTA/THIRTIES

ELENA

C04411



Mod. ELENA

C0441

Designed by ENRICO CASSINA



C0441

136x45



C0441/5

136x45



C55100

75x28



C04420

39x145



C0441 DK

35x146

TRENTA/THIRTIES

CARLA-MARIA

C08211



Mod. CARLA-MARIA

C08211

Designed by ENRICO CASSINA

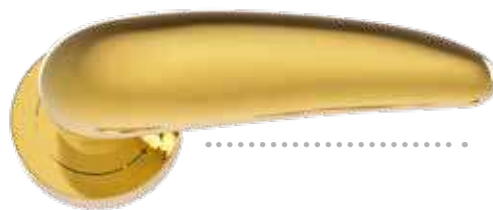

C08211
137x50



C08211/5
137x50



C54400
81x28



C08270
44x229



C08220
39x145



C08211 DK
35x145

TRENTA/THIRTIES

ELVIRA

C09211



Mod. ELVIRA

C09210

Designed by ENRICO CASSINA



C09210
87x232

Privacy
C09210/5
87x232



C09211
91x45



C09211/5
91x45



C54400
81x28



C09270
44x229



C09220
39x152



C09211 DK
30x101

TRENTA/THIRTIES

TOPAZIA

C09310



Mod. TOPAZIA

C09310

Designed by ENRICO CASSINA



C09310
71x232

Privacy
C09310/5
71x232



C09311
77x50



C09311/5
77x50



C54400
81x28



C09320
39x152



C09311 DK
30x84

TRENTA/THIRTIES

ADA

3000



Mod. ADA

3000

Designed by ENRICO CASSINA



3000
82x50

3000 C
82x50

3000 S
82x50

352
Ø50



C54400
81x28



3000 BO
74x62

3000 BO C
74x62

359 O
32x62

359 C
32x62

TRENTA/THIRTIES

ANJA

4801



Mod. ANJA
4801
Designed by ENRICO CASSINA

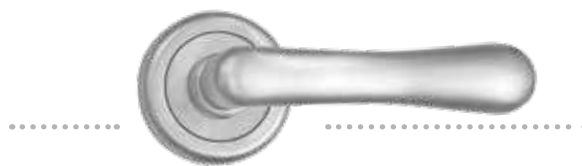

480190
120x50



480190/5
120x50



C54400
81x28



5700
28x88



4801 DK
30x127

A woman wearing a white hijab and white-rimmed sunglasses is smiling while driving a classic car. The car's interior, including the steering wheel and dashboard, is visible through the open driver-side window. The scene is captured in a blue-tinted, monochromatic style. The word "CINQUANTA" is overlaid in white, bold, sans-serif capital letters across the center of the image.

CINQUANTA

FIFTIES



CINQUANTA/FIFTIES

WIJDAN

C06611



Mod. WIJDAN

C06611

Designed by SERGIO ASTI



C06611
131x45



C06611/5
131x45



C55100
75x28



C06620
39x145

C06610 DK
39x182

CINQUANTA/FIFTIES

ANNA

C06911



Mod. ANNA

C06911

Designed by SERGIO ASTI



C06911
125x85



C06911/5
125x85



C55100
75x28



C06620
39x145

C06910 DK
39x185

CINQUANTA/FIFTIES

GAE

C06811



Mod. GAE

C06811

Designed by ENRICO CASSINA



C06811
135x45



C06811/5
135x45



C55100
28x75



C06870
44x256



C06820
39x145



C06811 DK
30x145



C06850
250 (31x275)

CINQUANTA/FIFTIES

AFRA

C07011



Mod. AFRA

C07011

Designed by SERGIO ASTI

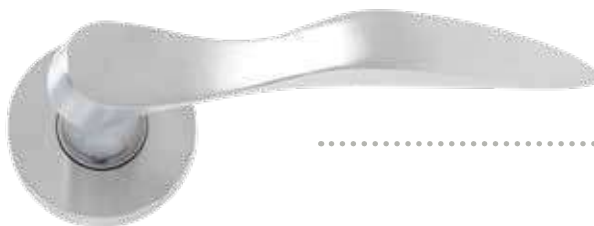

C07011
134x45



C07011/5
134x45



C55100
75x28



C07020
39x145

C07011 DK
30x144

CINQUANTA/FIFTIES

HUANG

C07911



Mod. HUANG

C07911

Designed by ENRICO CASSINA



C07911
132x45



C07911/5
132x45



C55100
75x28



C07970
44x256



C07920
39x145



C07911 DK
30x142



C07950
250 (25x275)

CINQUANTA/FIFTIES

KAZUYO

4803



Mod. KAZUYO

4803

Designed by ENRICO CASSINA



480390
134x50



480390/5
134x50



C55100
75x28



5701
34x70

CINQUANTA/FIFTIES

ODILE

4807



Mod. ODILE

4807

Designed by ENRICO CASSINA



480791
137x50



480791/5
137x50



C55100
75x28



4807 DK
30x145



732
250 (30x283)
400 (30x430)

Mod. ODILE

4807

Designed by ENRICO CASSINA

ENTRANCE SET

.....



820057_AC
820000
70x523
147x340



820157_AC
820100
70x520
147x340



821057_AC
821000
70x523
70x340



821157_AC
821100
70x520
70x340

Mod. ODILE

4807

Designed by ENRICO CASSINA

INSIDE SET



480792

145x66

CPR - Privacy
CPA - Passage
CDU - Dummy



485192

Ø66

CPR - Privacy
CPA - Passage
CDU - Dummy

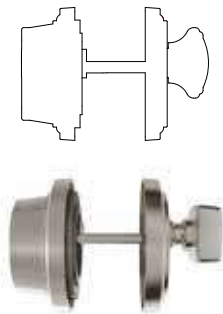

8200DR

Ø66

SC - Single Cylinder
DC - Double Cylinder

INSIDE SET

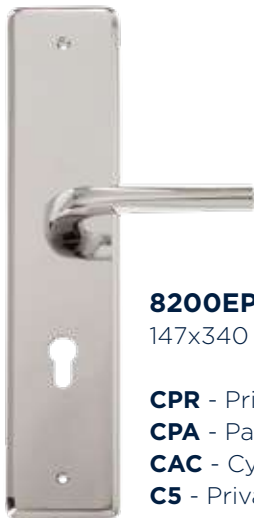

8200EP

147x340

CPR - Privacy
CPA - Passage
CAC - Cylinder
C5 - Privacy EUROPEAN
CPE - Passage EUROPEAN
C2 - Cylinder EUROPEAN



8210EP

70x340

CPR - Privacy
CPA - Passage
CAC - Cylinder
C5 - Privacy EUROPEAN
CPE - Passage EUROPEAN
C2 - Cylinder EUROPEAN

MULTIPOINT



480710

132x240

C25 - Double Cylinder
C05 - Passage
C26 - Patio

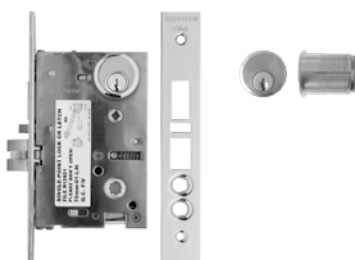

C400S

29
32
35
38

Disponibile serratura
Mortise lock available

A dark blue 3D rendering of a mechanical lever or handle assembly. The assembly consists of a rectangular base with a smaller rectangular block on top. A long, flat, rectangular handle is attached to the top block and is angled upwards and to the right. The word "INEDITA" is overlaid in white, bold, sans-serif font across the middle of the image.

INEDITA

INEDITA

LEONTIA



Mod. WINTER

C004

Designed by Alessio Rigamonti



C00498

139.5x49

C00498/5

139.5x49

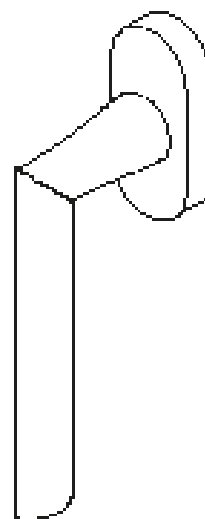

C00411_DK

30x147.5

Mod. UPPER

C006

Designed by Alessio Rigamonti



C00699

138x60

C00699/5

138x60

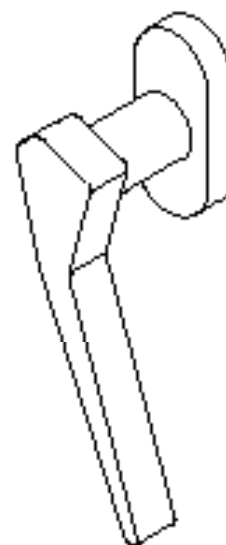

C00611_DK

50x145

Mod. VASILIJ

C008

Designed by Alessio Rigamonti



C00898

145x49

C00898/5

145x49

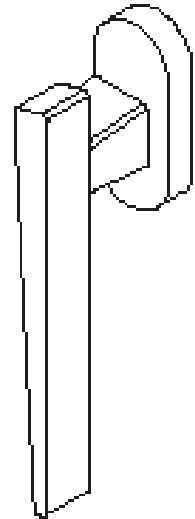

C00811_DK

30x145.5

Mod. LEONTIA

C009

Designed by Alessio Rigamonti



C00999

147.5x49

C00999/5

147.5x49

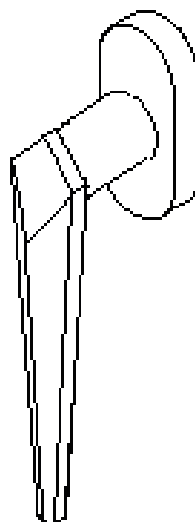

C00911_DK

30x156

INEDITA

AMAL

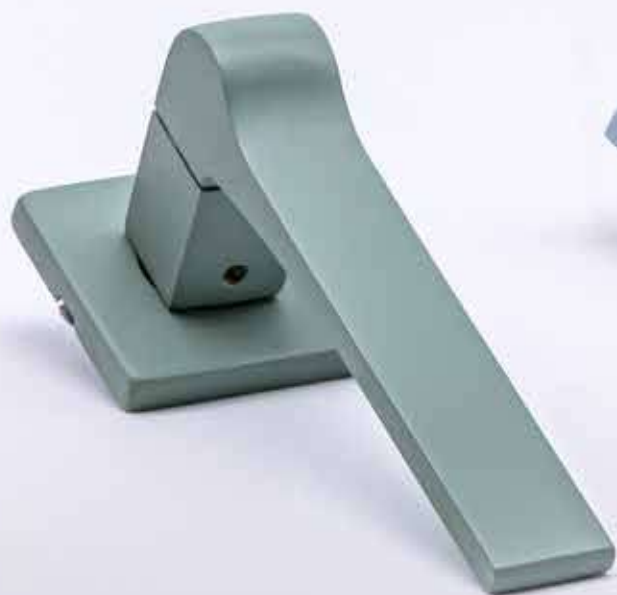

Mod. AMAL

C001

Designed by Alessio Rigamonti

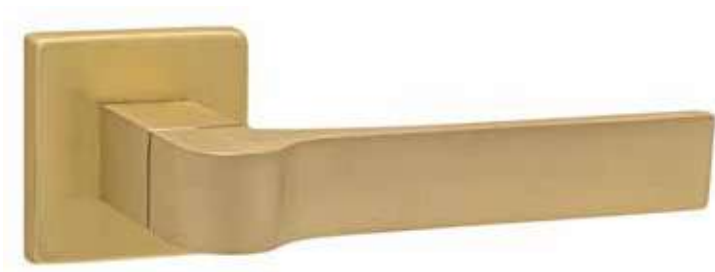

C00199

144x50

C00199/5

144x50

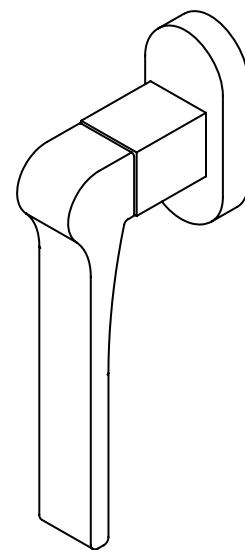

C00111_DK

30x151.5

Mod. SPRING

C002

Designed by Alessio Rigamonti



C00299

139x50

C00299/5

139x50

C00211_DK

30x147

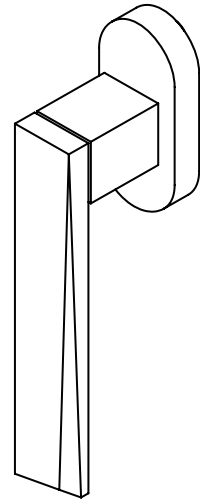

Mod. MONDO

C011

Designed by Alessio Rigamonti



C01198

136x49

C01198/5

136x49

C01111_DK

30x144

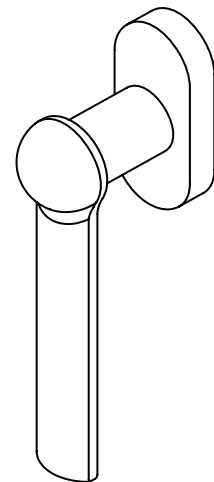

Mod. DODO

C0014

Designed by Alessio Rigamonti



C01498

136.5x49

C01498/5

136.5x49

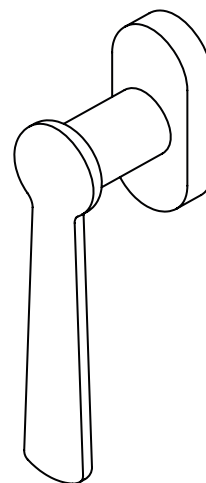

C01411_DK

30x144.5

Mod. GALA

C005

Designed by Alessio Rigamonti



C00598

147.5x49

C00598/5

147.5x49

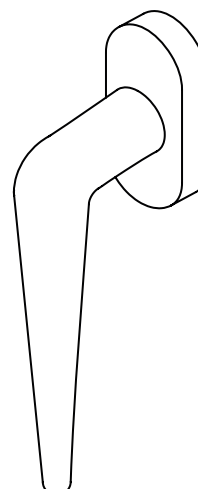

C00511_DK

30x156

INEDITA

DODO & GALA







**THE KNURLED
COLLECTION**

C01711

Designed by ENRICO CASSINA



C01711
132.5x50



C01711/5
132.5x50



C493

300 (Ø25x366)

400 (Ø25x466)

600 (Ø25x666)

800 (Ø25x866)



C217
Ø60x69



C523
Ø33.5x34.5



C01711 DK
30x140



C01720
39x152



ES!

ROCO CÒPOP



ROCOCÒPOP

ROCOCÒPOP

C12810



Mod. ROCOCÒPOP

C12810

Designed by MAADE



C12810
129x248

Privacy
C12810/5
129x248



C12811
123x80



C12811/5
123x80



C54600
89x33



CC4x3 BA
76x150

CC4x4 BA
102x150

CC5x4 BA
102x175



C52200
41x37



C12820
44x172



C12810 DK
54x165



**BAROCCO
ITALIANO**

ITALIAN
BAROQUE



BAROCCO ITALIANO/ITALIAN BAROQUE

LAVINIA

C12010



Mod. LAVINIA

C12010

Designed by ENRICO CASSINA



C12010
145x330

Privacy
C12010/5
145x330



C12011
133x72



C12011/5
133x72



C54000
87x32



C12020
40x180



C12010 DK
37x175

Mod. LAVINIA

C12010

Designed by ENRICO CASSINA

ENTRANCE SET



C40010_AC

65x450
145x330



C40010_00

65x450
145x330



C60500

65x450



C400S

29
32
35
38

Disponibile serratura
Mortise lock available



BAROCCO ITALIANO/ITALIAN BAROQUE

ARTEMISIA

C01910



Mod. ARTEMISIA

C01910

Designed by ENRICO CASSINA

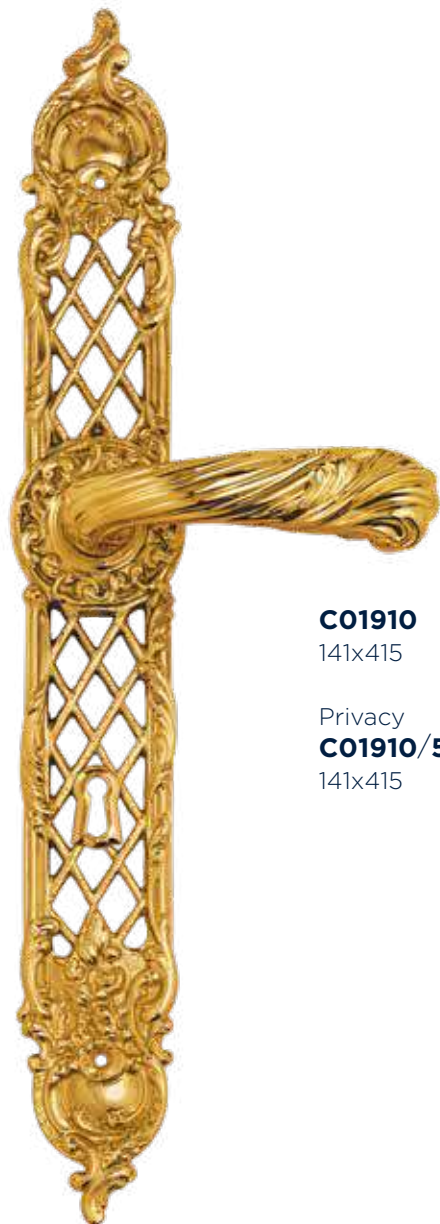

C01910
141x415

Privacy
C01910/5
141x415



C12011
133x72



C12011/5
133x72



C54000
87x32



C12020
40x180



C12010 DK
37x175

BAROCCO ITALIANO/ITALIAN BAROQUE

ELISABETTA

C01210



Mod. ELISABETTA

C01210

Designed by ENRICO CASSINA



C01215
132x82
C01217
(145x82)



C01215/5
132x82
C01217/5
(145x82)



C01210
127x288
C01216
140x288

Privacy
C01210/5
127x288
C01216/5
140x288



C54000
87x32



C01210 DK
38x170

BAROCCO ITALIANO/ITALIAN BAROQUE

BARBARA

C04312



Mod. BARBARA

C04312

Designed by ENRICO CASSINA



C04312
126x276

Privacy
C04312/5
126x276



C04315
127x89



C04315/5
127x89



C54200
90x27



C04320
41x180



C04310 DK
41x193

Mod. BARBARA

C04312

designed by ENRICO CASSINA



C31901

**Asta C319AS non inclusa
nella confezione**

Rod C319AS is not
included in the package



C30200

C30225 (Asta/Rod L 250mm)

C30230 (Asta/Rod L 300mm)

C30235 (Asta/Rod L 350mm)

C30240 (Asta/Rod L 400mm)



C04351

47x221



C0889

47x89





LUIGI
XV

LOUIS
XV



LUIGI XV/LOUIS XV

MARIE

C12811



Mod. MARIE

C12810

Designed by ENRICO CASSINA



C12810
129x248

Privacy
C12810/5
129x248



C12811
123x80

C12811/5
123x80



C54600
89x33



C12820
44x172

C12810 DK
54x165

LUIGI XV/LOUIS XV

POMPADOUR

C11910



Mod. POMPADOUR

C11910

Designed by ENRICO CASSINA



C11910
124x248

Privacy
C11910/5
124x248



C11911
118x80



C11911/5
118x80



C54600
89x33



C11920
44x172

C11910 DK
38x159

LUIGI XV/LOUIS XV

DU BARRY

C09110



Mod. DU BARRY

C09110

Designed by ENRICO CASSINA



C09110
110x248

Privacy
C09110/5
110x248

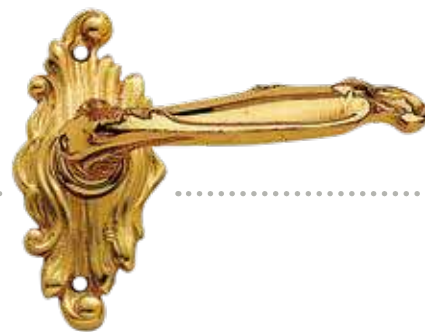

C09111
103x80



C09111/5
103x80



C54600
89x33



C09120
44x172



C09110 DK
36x145

LUIGI XV/LOUIS XV

ADELAIDE

C06710



Mod. ADELAIDE

C06710

Designed by ENRICO CASSINA



C06710

121x277

C06716

139x277

Privacy

C06710/5

121x277

C06716/5

139x277



C06715

125x85

C06717

144x85



C06715/5

125x85

C06717/5

144x85



C54000

87x32



C06710 DK

41x162

An ornate metal gate with a central panel featuring a sun face sculpture. The gate is highly decorative with intricate scrollwork and floral motifs. The background shows a city street with buildings.

LUIGI
XVI

LOUIS
XVI



LUIGI XVI/LOUIS XVI

MARIE-ANTOINETTE

C01610



Mod. MARIE-ANTOINETTE

C01610

Designed by ENRICO CASSINA



C01610
146x507

Privacy
C01610/5
146x507



C01615
141x75



C01615/5
141x75



C54600
89x33



C01610 DK
36x173

LUIGI XVI/LOUIS XVI

GABRIELLE

C01810



Mod. GABRIELLE

C01810

Designed by ENRICO CASSINA



C01810
142x358

Privacy
C01810/5
142x358

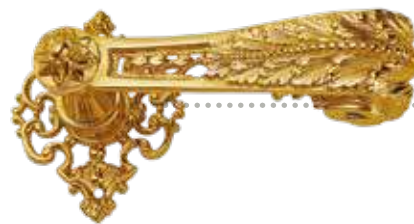

C01615
141x75



C01615/5
141x75



C54600
89x33



C01610 DK
36x173

LUIGI XVI/LOUIS XVI

SOFIA

C05115



Mod. SOFIA

C05110

Designed by ENRICO CASSINA



C05110
125x278
C05116
145x278

Privacy
C05110/5
125x278
C05116/5
145x278



C05115
128x75
C05117
148x75



C05115/5
128x75
C05117/5
148x75



C54600
89x33



C05110 DK
36x159



PRIMO
IMPERO

FIRST
EMPIRE



PRIMO IMPERO/FIRST EMPIRE

GIUSEPPINA

C12512



Mod. GIUSEPPINA

C12512

Designed by ENRICO CASSINA



C12512
115x300
C12518
142x300

Privacy
C12512/5
115x300
C12518/5
142x300



C12511
113x46
C12517
140x46



C12511/5
113x46
C12517/5
140x46



C54900
88x30



C12520
36x168



C12510 DK
33x140

PRIMO IMPERO/FIRST EMPIRE

MARIE-LOUISE

C12510



Mod. MARIE-LOUISE

C12510

Designed by ENRICO CASSINA



C12510
110x280
C12516
137x280

Privacy
C12510/5
110x280
C12516/5
137x280



C12511
113x46
C12517
140x46



C12511/5
113x46
C12517/5
140x46



C54900
88x30



C12520
36x168



C12510 DK
33x140

PRIMO IMPERO/FIRST EMPIRE

ELISA

C11010



Mod. ELISA

C11010

Designed by ENRICO CASSINA



C11010
118x280
C11016
130x280

Privacy
C11010/5
118x280
C11016/5
130x280



C11011
120x46
C11017
130x46



C11011/5
120x46
C11017/5
130x46



C54800
82x26



C11020
36x168



C11010 DK
33x147

PRIMO IMPERO/FIRST EMPIRE

PAOLINA

C05010



Mod. PAOLINA

C05010

Designed by ENRICO CASSINA



C05010
120x280

Privacy
C05010/5
120x280



C05011
123x46



C05011/5
123x46



C54800
82x26



C05010 DK
33x150

PRIMO IMPERO/FIRST EMPIRE

LETIZIA

C02011



Mod. LETIZIA

C02010

Designed by ENRICO CASSINA



C02010
107x280

Privacy
C02010/5
107x280



C02011
110x46



C02011/5
110x46



C54800
82x26



C02020
36x168



C02010 DK
33x137

PRIMO IMPERO / FIRST EMPIRE

CAROLINA

C09011



Mod. CAROLINA

C09010

Designed by ENRICO CASSINA



C09010
108x280

Privacy
C09010/5
108x280



C09011
111x46



C09011/5
111x46



C54800
82x26



C09020
36x168



C09010 DK
33x138

PRIMO IMPERO/FIRST EMPIRE

STEFANIA

C08311



Mod. STEFANIA

C08310

Designed by ENRICO CASSINA



C08310
120x280

Privacy
C08310/5
120x280



C08311
123x46



C08311/5
123x46



C54700
85x30



C08310 DK
33x151

PRIMO IMPERO / FIRST EMPIRE

ORTENSIA

716



Mod. ORTENSIA

716

Designed by ENRICO CASSINA



718
163x76



718/5
163x76



C54900
88x30



716
167x381

Privacy
716/5
167x381



719
(76x77)



715
250 (84x381)

Mod. ORTENSIA

716

Designed by ENRICO CASSINA

ENTRANCE SET

.....



800057_AC
800000
60x573
155x381



800157_AC
800100
60x573
155x381



801057_AC
801000
60x573
60x381



801157_AC
801100
60x573
60x381

Mod. ORTENSIA

716

Designed by ENRICO CASSINA

INTERIOR SET



480892

158x66

CPR - Privacy
CPA - Passage
CDU - Dummy



485292

Ø66

CPR - Privacy
CPA - Passage
CDU - Dummy

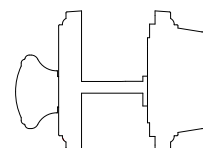

8000DR

Ø66

SC - Single Cylinder
DC - Double Cylinder

INSIDE SET



8000EP

155x381

CPR - Privacy
CPA - Passage
CAC - Cylinder
C5 - Privacy EUROPEAN
CPE - Passage EUROPEAN
C2 - Cylinder EUROPEAN



8010EP

60x381

CPR - Privacy
CPA - Passage
CAC - Cylinder
C5 - Privacy EUROPEAN
CPE - Passage EUROPEAN
C2 - Cylinder EUROPEAN



C400S

29
32
35
38

Disponibile serratura
Mortise lock available

PRIMO IMPERO/FIRST EMPIRE

CARLOTTA

722



Mod. CARLOTTA

722

Designed by ENRICO CASSINA



722
158x429

Privacy
722/5
158x429



724
157x63



724/5
157x63



C54900
88x30



721
280 (92x429)



423
280 (68x368)

The image shows a grand, ornate interior space, likely a museum or a historical building. The architecture is highly detailed, featuring large columns with intricate capitals, a high ceiling with a dome, and various decorative elements like carvings and sculptures. The lighting is dramatic, highlighting the textures and details of the architecture. The overall color palette is a deep, monochromatic blue.

SECONDO
IMPERO

SECONDO
EMPIRE



SECONDO IMPERO/SECOND EMPIRE

EUGENIE

C08711



Mod. EUGENIE

C08710

Designed by ENRICO CASSINA



C08710
120x270

Privacy
C08710/5
120x270



C08711
118x38



C08711/5
118x38



C54900
88x30



C08720
38x170



C08710 DK
33x149



C08750
38x186

SECONDO IMPERO/SECOND EMPIRE

ELEONORE

C00710



Mod. ELEONORE

C00710

Designed by ENRICO CASSINA



C00710
122x289

Privacy
C00710/5
122x289



C00711
120x45



C00711/5
120x45



C54800
82x26



C00710 DK
33x148



C45201
45x177

SECONDO IMPERO/SECOND EMPIRE

MATILDE

C13510



Mod. MATILDE

C13510

Designed by ENRICO CASSINA

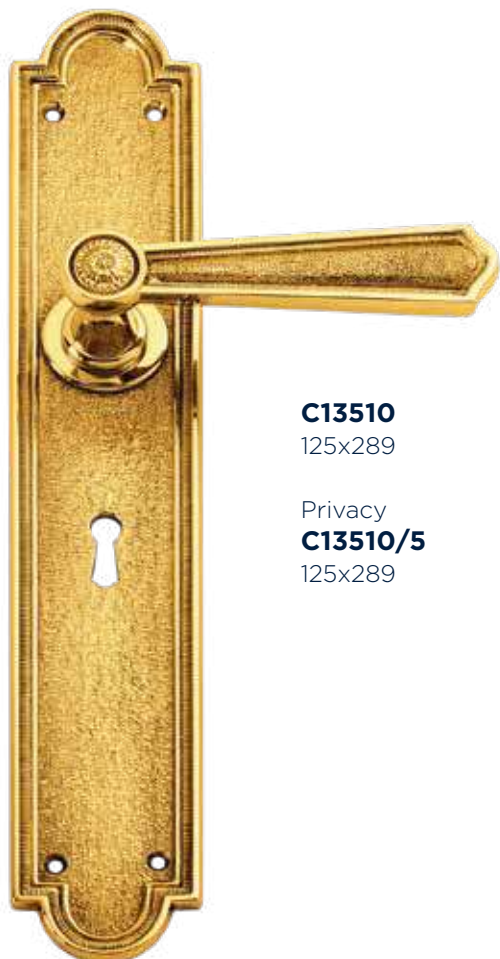

C13510
125x289

Privacy
C13510/5
125x289



C13511
121x45



C13511/5
121x45



C54800
82x26



C13510 DK
33x149

SECONDO IMPERO/SECOND EMPIRE

VIRGINIA

C12210



Mod. VIRGINIA

C12210

Designed by ENRICO CASSINA



C12210
125x289

Privacy
C12210/5
125x289



C12211
119x38



C12211/5
119x38



C54300
86x33



C12210 DK
33x150



C60800
73x305



COLONIALE

COLONIAL



COLONIALE/COLONIAL

VITTORIA

C12110



Mod. VITTORIA

C12110

Designed by ENRICO CASSINA



C12110
143x314

Privacy
C12110/5
143x314



C12111
156x78



C12111/5
156x78



C54500
75x34



C12110 DK
35x184

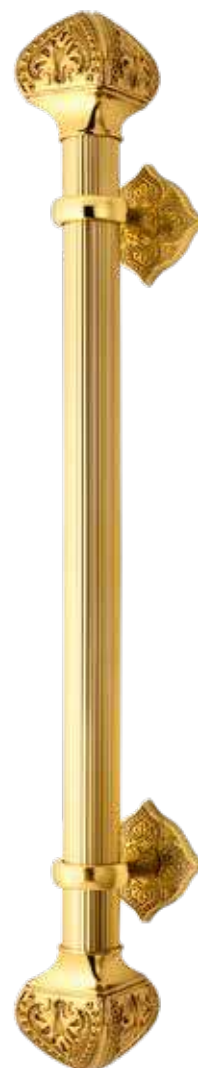

C49200
400 (69x617)
600 (69x817)
800 (69x1017)

COLONIALE/COLONIAL

CLEMENTINA

C14010



Mod. CLEMENTINA

C14010

Designed by ENRICO CASSINA



C14010
124x246

Privacy
C14010/5
124x246



C14011
127x45



C14011/5
127x45



Con la rosetta Ø45mm non è possibile utilizzare la molla e il foro cilindro

With the 45mmØ rose, the spring and the yale key hole can not be used.



C55000
94x33



C14020
38x145



C14011 DK
32x137



C14050
45x250

COLONIALE/COLONIAL

MENEN

C12710



Mod. MENEN

C12710

Designed by ENRICO CASSINA



C12710
126x224

Privacy
C12710/5
126x224



C12711
128x45



C12711/5
128x45



Con la rosetta Ø45mm non è possibile utilizzare la molla e il foro cilindro

With the 45mmØ rose, the spring and the yale key hole can not be used.



C55000
94x33



C12720
39x153



C12711 DK
30x138



C12750
45x173

COLONIALE/COLONIAL

EMANUELA

4800



Mod. EMANUELA

4800

Designed by ENRICO CASSINA



480001
118x223

Privacy
480001/5
118x223



480090
124x50



480090/5
124x50



C54500
75x34



4800 DK
30x132

COLONIALE/COLONIAL

INDIRA

4806



Mod. INDIRA

4806

Designed by ENRICO CASSINA

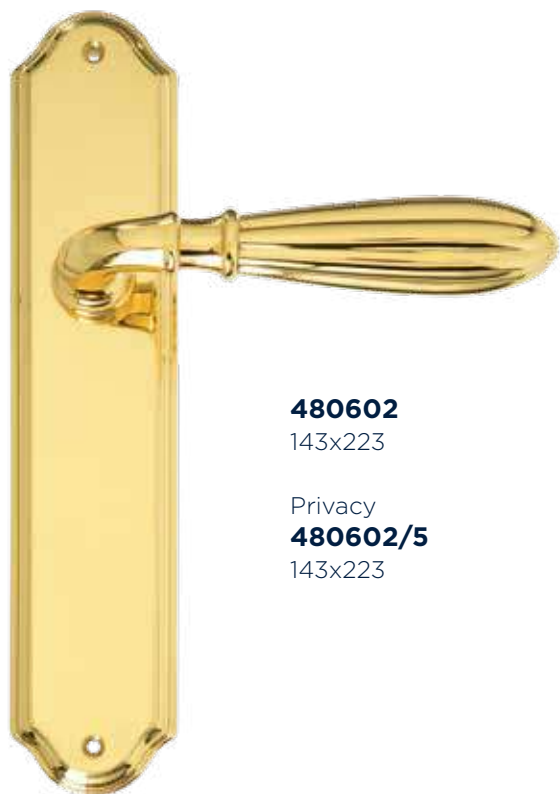

480602
143x223

Privacy
480602/5
143x223



480690
146x50



480690/5
146x50



C54500
75x34



4806 DK
32x153



728
235 (53x288)

Mod. INDIRA

4806

Designed by ENRICO CASSINA

ENTRANCE SET

.....



810057_AC
810000
70x503
156x340



810157_AC
810100
70x505
156x340



811057_AC
811000
70x503
70x340



811157_AC
811100
70x505
70x340

Mod. INDIRA

4806

Designed by ENRICO CASSINA

INTERIOR SET



480692

154x66

CPR - Privacy
CPA - Passage
CDU - Dummy



485092

Ø66

CPR - Privacy
CPA - Passage
CDU - Dummy



8100DR

Ø66

SC - Single Cylinder
DC - Double Cylinder

INSIDE SET



8100EP

156x340

CPR - Privacy
CPA - Passage
CAC - Cylinder
C5 - Privacy EUROPEAN
CPE - Passage EUROPEAN
C2 - Cylinder EUROPEAN



8110EP

70x340

CPR - Privacy
CPA - Passage
CAC - Cylinder
C5 - Privacy EUROPEAN
CPE - Passage EUROPEAN
C2 - Cylinder EUROPEAN

MULTIPOINT



480620

141x240

C25 - Double Cylinder
C05 - Passage
C26 - Patio



C400S

29
32
35
38

Disponibile serratura
Mortise lock available



MOSAICO

MOSAIC



MOSAICO/MOSAIC

MOSAICO*

C473



Mod. MOSAICO*

C471 - C472 - C473

Designed by ENRICO CASSINA



VILLA OLMO
C471
160x350



VILLA CARLOTTA
C472
127x320



VILLA ERBA
C473
102x536

*con foglia d'oro 24k
*with 24k gold leaf

MADREPERLA

MOTHER OF PEARL



MADREPERLA/MOTHER OF PEARL

MADREPERLA

C03010



Mod. MADREPERLA

C03010

Designed by ENRICO CASSINA



C03010
152x300

Privacy
C03010/5
152x300



C03011
154x58



C03011/5
154x58



C54400
81x28



C03011 DK
43x158



C23000
Ø81xh65



C23000 Q
Ø81xh65
Rosetta/Rose Ø58



CB3060
Ø58



C03050
58x310



**ÉLITE
COLLECTION**

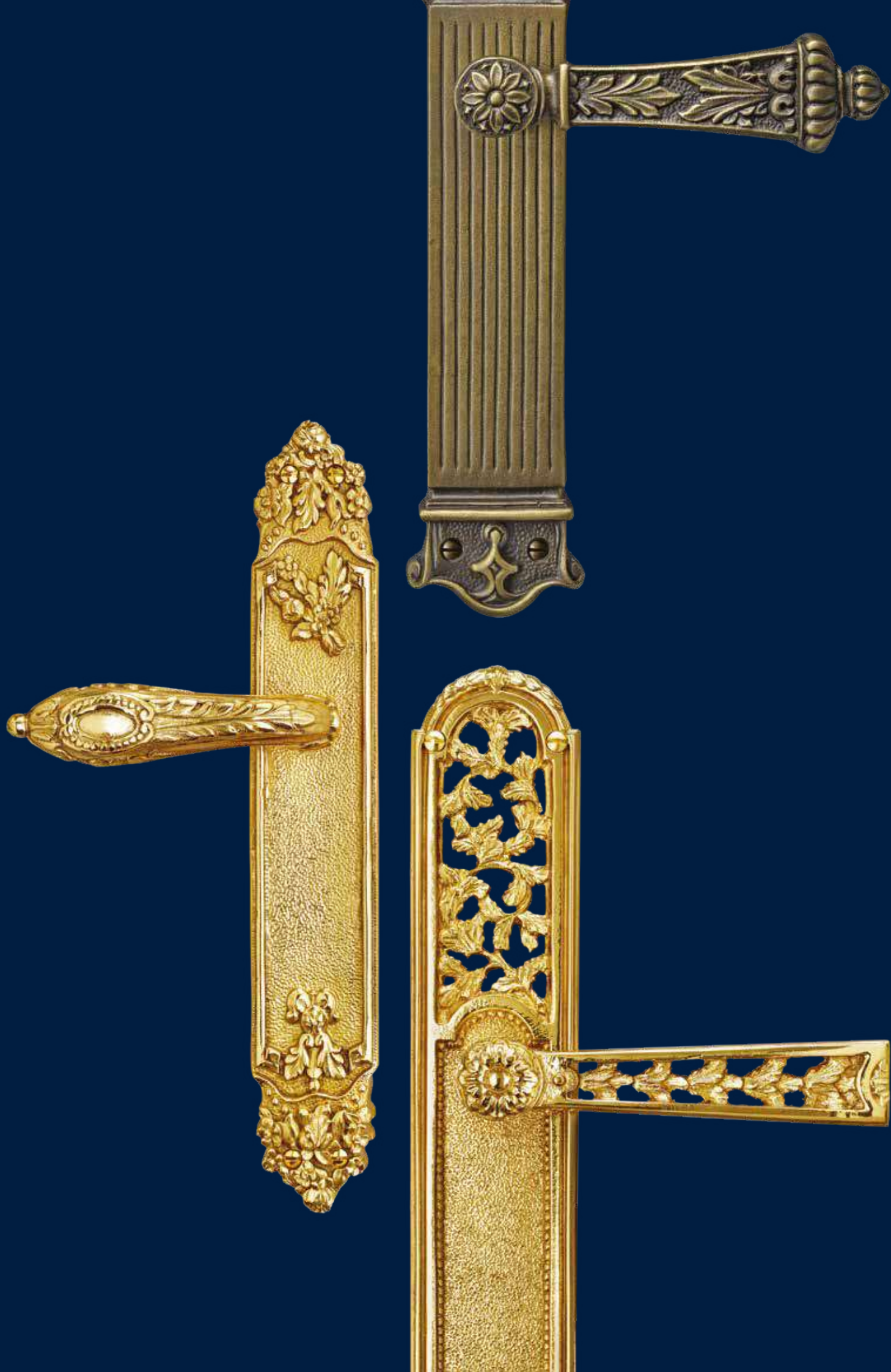

ÉLITE COLLECTION

EVEREST

A00110



Mod. EVEREST

A00110

Designed by ENRICO CASSINA



A00110

Privacy
A00110/5

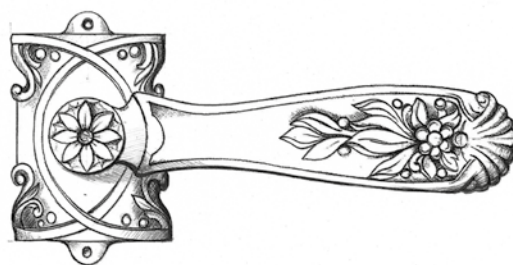

A00111



A00111/5

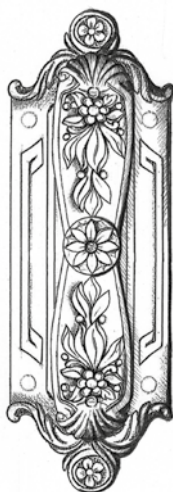

A00120

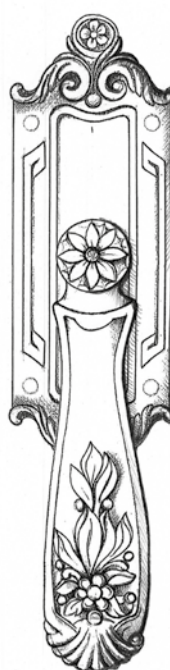

A00110 DK

ÉLITE COLLECTION

SAHARA

A00210



Mod. SAHARA

A00210

Designed by ENRICO CASSINA



A00210

Privacy
A00210/5

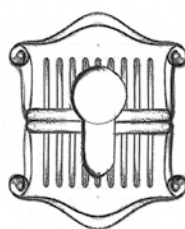
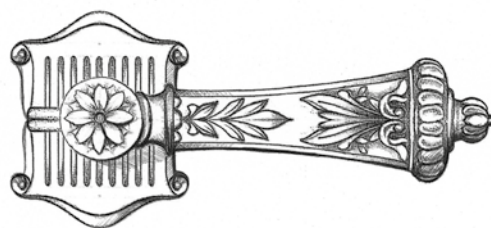

A00211

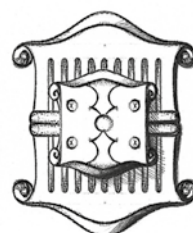

A00211/5

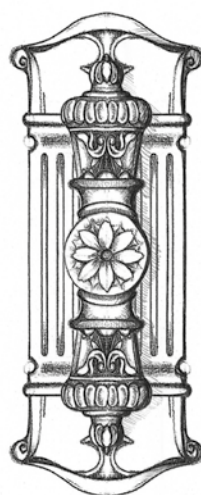
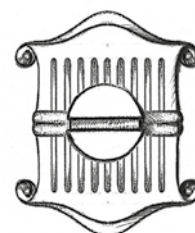

A00220

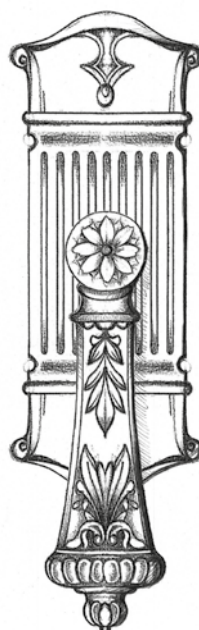

A00210 DK

ÉLITE COLLECTION

ULURU

A00310



Mod. ULURU

A00310

Designed by ENRICO CASSINA



A00310

Privacy
A00310/5

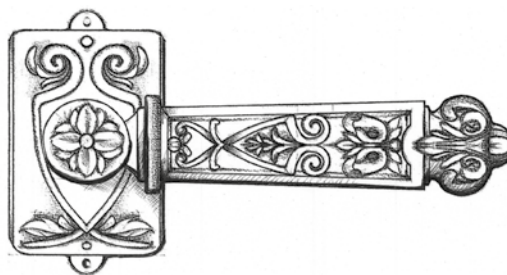

A00311

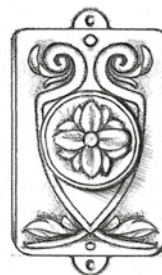

A00311/5



A00320



A00310 DK

ÉLITE COLLECTION

VULCANO

A00410



Mod. VULCANO

A00410

Designed by ENRICO CASSINA



A00410

Privacy
A00410/5



A00411



A00411/5



A00420



A00410 DK

ÉLITE COLLECTION

CARAIBI

A00510



Mod. CARAIBI

A00510

Designed by ENRICO CASSINA



A00510

Privacy
A00510/5



A00511



A00511/5



A00520



A00510 DK

ÉLITE COLLECTION

AMAZZONIA

A00610



Mod. AMAZZONIA

A00610

Designed by ENRICO CASSINA



A00610

Privacy
A00610/5

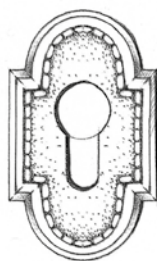
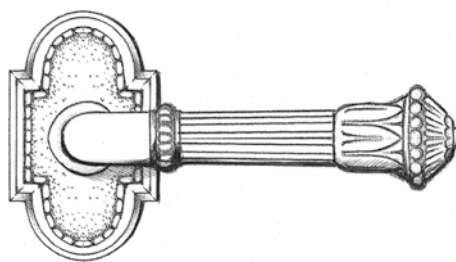

A00611



A00611/5

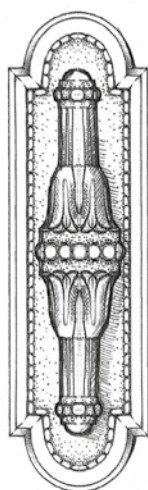
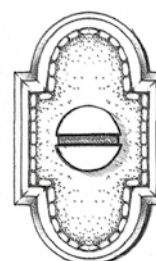

A00620

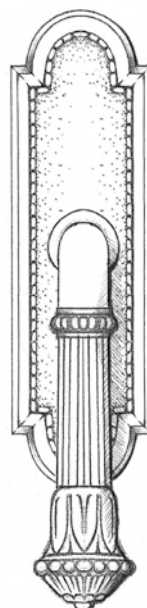

A00610 DK

ÉLITE COLLECTION

BLUE HOLE

A00710



Mod. BLUE HOLE

A00710

Designed by ENRICO CASSINA



A00710

Privacy
A00710/5

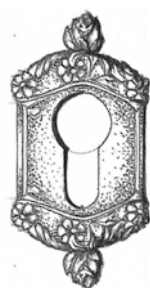
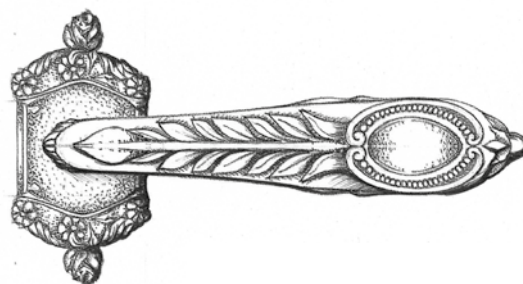

A00711



A00711/5

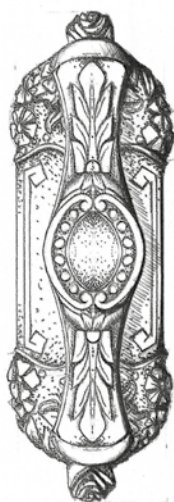

A00720

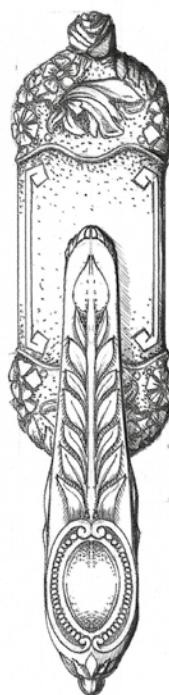

A00710 DK

ÉLITE COLLECTION

COLUMBIA

A00810



Mod. COLUMBIA

A00810

Designed by ENRICO CASSINA



A00810

Privacy
A00810/5

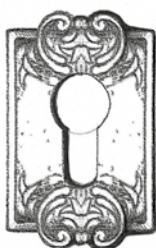
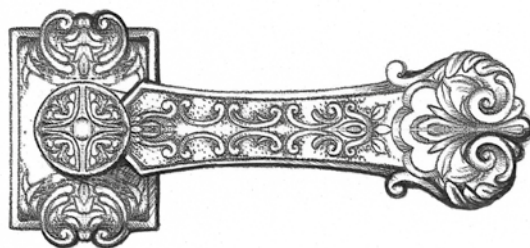

A00811
154x58



A00811/5
154x58



A00820
58x310



A00810 DK
Ø58

ÉLITE COLLECTION

ANDROS

A00910



Mod. ANDROS

A00910

Designed by ENRICO CASSINA



A00910

Privacy
A00910/5

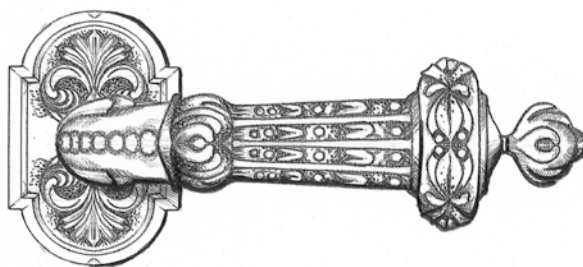

A00911



A00911/5

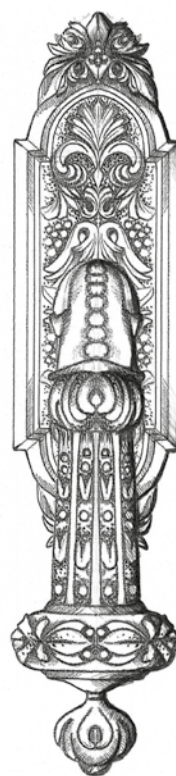
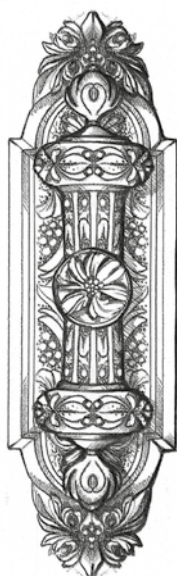

A00910 DK



SERVIZIO
PERSONALIZZATO

BESPOKE
SERVICE

SU MISURA

Per chi non vuole rinunciare alla purezza dello stile ma ha necessità particolari tutte le Maniglie Enrico Cassina possono essere personalizzate.

Una personalizzazione dimensionale, per rendere la maniglia ergonomicamente adatta al singolo Cliente ma anche, quando necessario, per adattarla alle dimensioni particolari di portali o finestratezze mantenendo equilibrata l'immagine d'insieme.

Come tutti i prodotti Officine Meccaniche Porro anche le maniglie Enrico Cassina possono avere, oltre alle finiture da noi consigliate, la finitura che più soddisfa il gusto di ogni nostro Cliente.

CUSTOMIZED

The Enrico Cassina handles can be customized for those who do not want to give up purity of style, but have special requirements to meet.

We can customize sizes to ergonomically adjust the handle to the customer's own specifications, and, when necessary, to the special measurements of windows and doors, while also maintaining all proportions in equilibrium.

Like all Officine Meccaniche Porro products, Enrico Cassina handles can feature either our standard finishes or those requested by our clients.

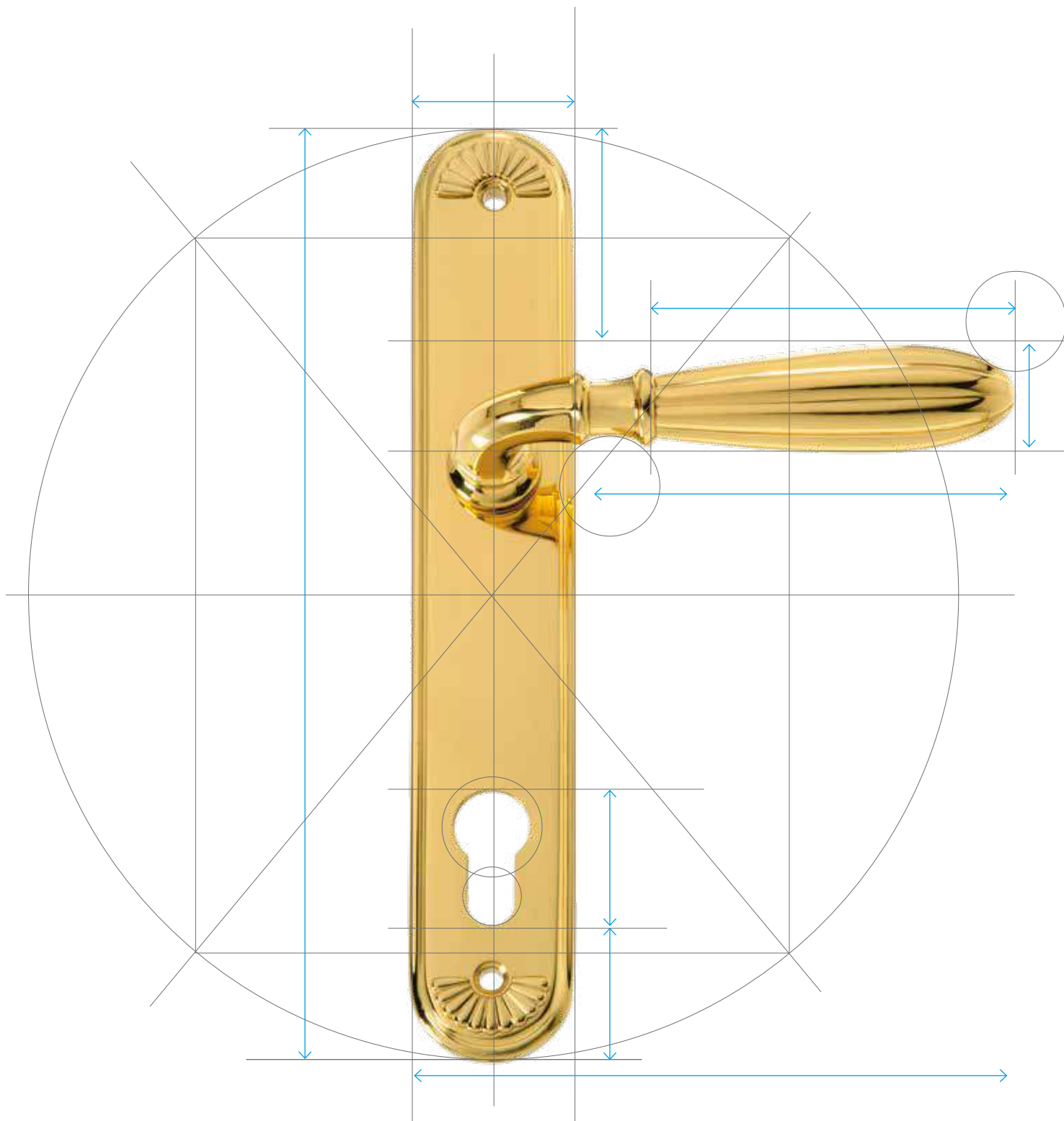



ACCESSORI
PORTA

DOOR
ACCESSORIES



MANIGLIONI
PULL HANDLES

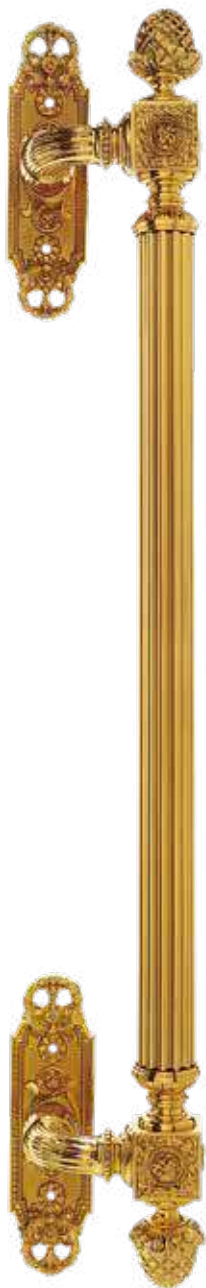

C49000
600 (122x788)
800 (122x988)
1000 (122x1188)

PRIMO IMPERO
FIRST EMPIRE



CB2400
54x188



C48600
600 (125x820)
800 (125x1020)
1000 (125x1220)



CB2770
Ø70

SECONDO IMPERO
SECOND EMPIRE



C49100
600 (123x880)
800 (123x1080)
1000 (123x1280)



CB2290
90x90

BAROCCO ITALIANO
LUIGI XV
LUIGI XVI
ITALIAN BAROQUE
LOUIS XV
LOUIS XVI

MANIGLIONI

 PULL HANDLES



C49200
400 (69x617)
600 (69x817)
800 (69x1017)



CB1678
 78x78

COLONIALE
 COLONIAL



C47800
400 (45x520)
600 (45x720)
800 (45x920)



CB1860
 45x60

ART DÉCO

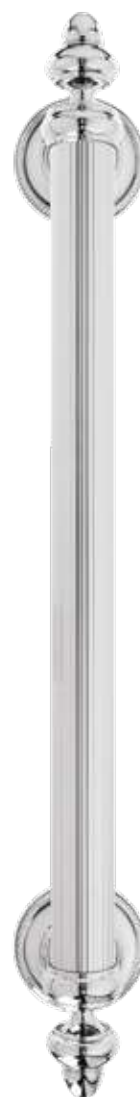

C48800
400 (68x513)
600 (68x713)
800 (68x913)



CB1968
 Ø68

NOVECENTO
 XX CENTURY

MANIGLIONI

PULL HANDLES



709 R
250 (84x303)
500 (84x553)

NOVECENTO
XX CENTURY



709
250 (84x303)
500 (84x553)

NOVECENTO
XX CENTURY



713
250 (85x304)
500 (99x554)



705
235 (70x244)
400 (73x460)

COLONIALE
COLONIAL

MANIGLIONI
PULL HANDLES



732
250 (30x283)
400 (30x430)

CINQUANTA
FIFTIES



C09550
38x368



CB1489
38x89

ART DÉCO



C09450
48x333



CB1384
44x84

ART NOUVEAU



C02950
23x290



CB3350
50x50

TRENTA
THIRTIES

MANIGLIONI
PULL HANDLES



C42700
87x460

SECONDO IMPERO
SECOND EMPIRE



721
280 (92x429)

PRIMO IMPERO
FIRST EMPIRE



715
250 (84x381)

PRIMO IMPERO
FIRST EMPIRE



C09650
48x360

ART NOUVEAU

MANIGLIONI
PULL HANDLES



423
280 (68x368)

PRIMO IMPERO
FIRST EMPIRE



C42200
64x332

PRIMO IMPERO
FIRST EMPIRE



C42400
67x288

PRIMO IMPERO
FIRST EMPIRE



C14050
45x250



CB2045
Ø45

COLONIALE
COLONIAL

MANIGLIONI
PULL HANDLES



711
200 (53x254)
300 (75x375)

COLONIALE
NOVECENTO
COLONIAL
XX CENTURY



728
235 (53x288)

COLONIALE
COLONIAL



706
280 (73x278)

COLONIALE
COLONIAL



706 O
280 (54x278)

COLONIALE
COLONIAL

MANIGLIONI
PULL HANDLES



C13050
45x275



CB2045
Ø45

NOVECENTO
XX CENTURY



C10150
58x272



CB1558
58x58

NOVECENTO
XX CENTURY



C06850
250 (31x275)



CB0945
Ø45

CINQUANTA
FIFTIES



C07950
250 (25x275)



CB0945
Ø45

CINQUANTA
FIFTIES

MANIGLIONI
PULL HANDLES



C05450
250 (28x271)



CB3350
50x50

TRENTA
THIRTIES



714
200 (50x265)

714 D
128 (43x170)



C17350
45x251



CB2045
Ø45

NOVECENTO
XX CENTURY



710
200 (60x250)

TRENTA
THIRTIES

MANIGLIONI
PULL HANDLES



C09950
192 (45x237)

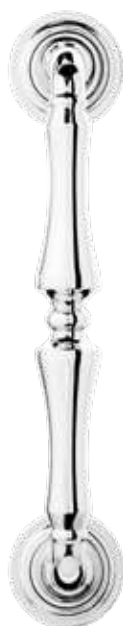

C16250
45x237



C43600
45x223



C13850
45x209



CB2045
Ø45

NOVECENTO
XX CENTURY



CB2045
Ø45

NOVECENTO
XX CENTURY



CB2045
Ø45

NOVECENTO
XX CENTURY



CB2045
Ø45

NOVECENTO
XX CENTURY

MANIGLIONI
PULL HANDLES



CB0538
Ø38

C08750
38x186



CB0445
Ø45

C45201
45x177



C12750
45x173

SECONDO IMPERO
SECOND EMPIRE

SECONDO IMPERO
SECOND EMPIRE



CB2045
Ø45



CB0889
47x89

C04351
47x221



CB0345
Ø46

C44900
46x191



BAROCCO ITALIANO
ITALIAN BAROQUE

PRIMO IMPERO
FIRST EMPIRE

COLONIALE
COLONIAL

MANIGLIONI
PULL HANDLES



VILLA ERBA*
C473
102x536

MOSAICO
MOSAIC

*con foglia d'oro
*with gold leaf



VILLA CARLOTTA*
C472
127x320
MOSAICO
MOSAIC



VILLA OLMO*
C471
160x350
MOSAICO
MOSAIC



CB3060
Ø58
CRISTALLI
CRYSTALS
MADREPERLA
MOTHER OF PEARL

C03050
58x310
MADREPERLA
MOTHER OF PEARL

MANIGLIONI AMERICANI
ENTRANCE SET



C40010_AC
65x450
145x330

C40010_00
65x450
145x330

BAROCCO ITALIANO
ITALIAN BAROQUE

MANIGLIONI AMERICANI

ENTRANCE SET



800057_AC
800000
60x573
155x381



800157_AC
800100
60x573
155x381



801057_AC
801000
60x573
60x381



801157_AC
801100
60x573
60x381

PRIMO IMPERO
FIRST EMPIRE

MANIGLIONI AMERICANI

ENTRANCE SET



810057_AC
810000
70x503
156x340



810157_AC
810100
70x505
156x340



811057_AC
811000
70x503
70x340



811157_AC
811100
70x505
70x340

COLONIALE
COLONIAL

MANIGLIONI AMERICANI
ENTRANCE SET



830057_AC
830000
70x503
155x340



830157_AC
830100
70x495
155x340



831057_AC
831000
70x503
70x340



831157_AC
831100
70x495
70x340

MANIGLIONI AMERICANI
ENTRANCE SET



C41000_AC
70x523
70x143



C41000_00
70x523
70x143

NOVECENTO
XX CENTURY

MANIGLIONI AMERICANI

ENTRANCE SET



820057_AC
820000
70x523
147x340



820157_AC
820100
70x520
147x340



821057_AC
821000
70x523
70x340



821157_AC
821100
70x520
70x340

CINQUANTA
FIFTIES

BATTENTI
DOOR KNOCKERS



701
100 (100x127)
125 (123x158)
150 (149x194)

COLONIALE
COLONIAL



645
110 (110x208)
150 (155x290)

PRIMO IMPERO
FIRST EMPIRE



700
100 (100x128)
125 (125x153)
150 (150x192)

COLONIALE
COLONIAL

BATTENTI
DOOR KNOCKERS



702
100 (89x130)
125 (112x158)
150 (133x192)

NOVECENTO
XX CENTURY



703
125 (117x161)
150 (137x191)

COLONIALE
COLONIAL

MANIGLIE INCASSO FLUSH HANDLES



C50500
41x116

C50500 FC
41x116



C50700
Ø64



C507AC
Ø64



BAROCCO ITALIANO
LUIGI XV
LUIGI XVI
ITALIAN BAROQUE
LOUIS XV
LOUIS XVI

BAROCCO ITALIANO
LUIGI XV
LUIGI XVI
ITALIAN BAROQUE
LOUIS XV
LOUIS XVI

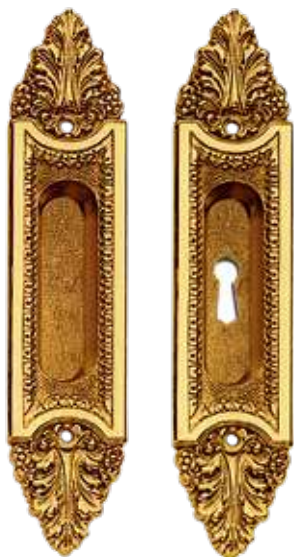

C50900
37x164

C50900 FC
37x164



C50400
43x108



C50400 FC
43x108

SECONDO IMPERO
SECOND EMPIRE

BAROCCO ITALIANO
ITALIAN BAROQUE

MANIGLIE INCASSO

FLUSH HANDLES



C50300
Ø64



C503 AC
Ø64



C50100
35x169



C50100 FC
35x169

PRIMO IMPERO
FIRST EMPIRE

PRIMO IMPERO
FIRST EMPIRE



C50800
35x119



C50800 FC
35x119

SECONDO IMPERO
SECOND EMPIRE



C51000
37x121



C51000 FC
37x121

NOVECENTO
XX CENTURY

PLACCHE PUSH-PULL

PUSH PLATES



C60500
65x450

BAROCCO ITALIANO
ITALIAN BAROQUE



C60400
88X380

BAROCCO ITALIANO
ITALIAN BAROQUE



C60800
73x305

SECONDO IMPERO
SECOND EMPIRE



C61100
76x187

PRIMO IMPERO
FIRST EMPIRE

POMOLI CENTROPORTE
DOOR KNOBS



C29900
Ø200

PRIMO IMPERO
FIRST EMPIRE



C29800
Ø200

NOVECENTO
XX CENTURY

POMOLI PORTA

 DOOR KNOBS



C22401 Q
 45x85



C22401
 45x85



C21200 Q
 Ø60



C21200
 Ø60



CB1085
 45x85

LUIGI XV
 LOUIS XV



CB2360
 Ø60

LUIGI XVI
 SECONDO IMPERO
 LOUIS XVI
 SECOND EMPIRE



135
60 (60xh45)
75 (75xh56)

LUIGI XV
 COLONIALE
 LOUIS XV
 COLONIAL



C22900 Q
 46x65xh56



C22900
 46x65xh56



CB0345
 Ø46

PRIMO IMPERO
 FIRST EMPIRE

POMOLI PORTA

 DOOR KNOBS



C25500
 Ø80



C25500 Q
 Ø80



CB2580
 Ø80

PRIMO IMPERO
 FIRST EMPIRE



C21100
 Ø62



C21100 Q
 Ø62



CB2855
 Ø55

PRIMO IMPERO
 FIRST EMPIRE



C21102
 Ø130

PRIMO IMPERO
 FIRST EMPIRE



C21101
 76x187xh44

PRIMO IMPERO
 FIRST EMPIRE



POMOLI PORTA
DOOR KNOBS



719
76x77xh59

PRIMO IMPERO
FIRST EMPIRE



C21800
51x95



C21800 Q
51x95



CB0345
Ø46



C25800
42x89



C25800 Q
42x89

PRIMO IMPERO
FIRST EMPIRE



C25901
46x75xh53



C25901 Q
46x75xh53



CB0345
Ø46



CB2689
42x89

PRIMO IMPERO
FIRST EMPIRE

PRIMO IMPERO
FIRST EMPIRE

POMOLI PORTA
DOOR KNOBS



C24400
Ø100



C24400 Q
Ø100



CB2770
Ø70

PRIMO IMPERO
FIRST EMPIRE



C24401
Ø70



C24401 Q
Ø70



CB2770
Ø70

PRIMO IMPERO
FIRST EMPIRE



C21500
Ø55x77xh49



C21500 Q
Ø55x77xh49



CB2855
Ø55

SECONDO IMPERO
SECOND EMPIRE

POMOLI PORTA
DOOR KNOBS



C21301
Ø55xh48



C21301 Q
Ø55xh48



CB2855
Ø55

SECONDO IMPERO
SECOND EMPIRE



C24100
38x69xh50



C24100 Q
38x69xh50



CB0538
Ø38

SECONDO IMPERO
SECOND EMPIRE



C21300
Ø100xh57



C21300 Q
Ø100xh57



CB2770
Ø70

SECONDO IMPERO
SECOND EMPIRE

POMOLI PORTA
DOOR KNOBS



170
55 (Ø55x55)



170 Q
55 (Ø55x65)



352
Ø50

COLONIALE
NOVECENTO
COLONIAL
XX CENTURY



354 C
Ø50



354 S
Ø50



354 O
Ø50



354
Ø50

COLONIALE
NOVECENTO
COLONIAL
XX CENTURY

POMOLI PORTA

 DOOR KNOBS



168 Q
70 (68x79)



355
 Ø54



355 C
 Ø54



355 S
 Ø54



355 O
 Ø54

COLONIALE
 COLONIAL



C29400
 48x118



C29400 Q
 48x118



CB1384
 44x84



168
70 (87x82)
85 (98x94)

ART NOUVEAU

COLONIALE
 COLONIAL

POMOLI PORTA
DOOR KNOBS



169
60 (78x67)
70 (90x70)
90 (90x74)

NOVECENTO
XX CENTURY



169Q
60 (58x65)
70 (68x66)



354
Ø50



354 C
Ø50



354 S
Ø50



354 O
Ø50



352
Ø50

NOVECENTO
XX CENTURY

POMOLI PORTA
DOOR KNOBS



C20400
70xh61



C20400 Q
70xh61



CB2770
Ø70

NOVECENTO
XX CENTURY



C20100
58x58xh64



C20100 Q
58x58xh64



CB1558
58x58

NOVECENTO
XX CENTURY



C24600
Ø65xh50



C24600 Q
Ø65xh50



CB2965
Ø65

NOVECENTO
XX CENTURY

POMOLI PORTA
DOOR KNOBS



C27800
60x60xh55



C27800 Q
60x60xh55



CB1860
45x60

ART DÉCO



C29500
50xh65



C29500 Q
50xh65



CB2150
Ø50

ART DÉCO



C23100
50x50xh59



C23100 Q
50x50xh59



CB3350
50x50

TRENTA
THIRTIES

POMOLI PORTA
DOOR KNOBS



181
50 (50x55)
70 (74x70)



TRENTA
CINQUANTA
THIRTIES
FIFTIES



C23000
Ø81xh65



C23000 Q
Ø81xh65
Rosetta/Rose
Ø58



CB3060
Ø58

MATERIE PREZIOSE
PRECIOUS MATERIALS

CERNIERE
DOOR HINGES



CC5x4 BA
102x175



CC4x4 BA
102x150



CC4x3 BA
76x150

BAROCCO ITALIANO
LUIGI XV
LUIGI XVI
ITALIAN BAROQUE
LOUIS XV
LOUIS XVI



CC5x4 IM
102x171



CC4x4 IM
102x146



CC4x3 IM
76x146

PRIMO IMPERO
FIRST EMPIRE

COPRI CERNIERE

HINGE COVERS



1121

Ø14 (16x37)

Ø14 (16x58)

Ø16 (18x37)

Ø16 (18x58)



1120

Ø14 (16x53)

Ø14 (16x74)

Ø16 (18x53)

Ø16 (18x74)

FINALI*

END-KNOBS*



CCF16A

19x17



CCF16D

16x16



CCF16B

16x17



CCF16E

18x14



CCF16G

16x9



CCF16C

16x15



CCF16F

16x5

*Applicabili alle nostre cerniere: CC1110 - CC2110 - CC1010 - CC2010

*Suitable for our door hinges: CC1110 - CC2110 - CC1010 - CC2010

CERNIERE
DOOR HINGES



CC1110
75x120



CC2110
61x120

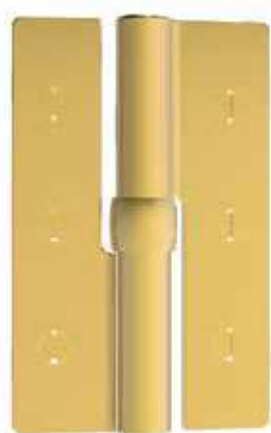

CC1010
75x120



CC2010
61x120

FERMAPORTE

 DOOR STOPS



C52200
 41x37

BAROCCO ITALIANO
 LUIGI XV
 LUIGI XVI
 ITALIAN BAROQUE
 LOUIS XV
 LOUIS XVI



C52100
 41x41

IMPERO
 EMPIRE



C52000
 41x42

COLONIALE
 NOVECENTO
 COLONIAL
 XX CENTURY



1307
 33x34

NOVECENTO
 ART DÉCO
 THE SIGN PROJECT
 XX CENTURY



1305
 45x30

COLONIALE
 ART NOUVEAU
 NOVECENTO
 TRENTA
 COLONIAL
 XX CENTURY
 THIRTIES



1147
 22x78

NOVECENTO
 XX CENTURY



1148
 32x95

NOVECENTO
 XX CENTURY

CARIGLIONI E CATENACCI

CREMONE BOLTS AND SLIDING BOLTS

C31901

**Asta C319AS non inclusa
nella confezione**

Rod C319AS is not
included in the package



C30200

C30225 (Asta/Rod L 250mm)

C30230 (Asta/Rod L 300mm)

C30235 (Asta/Rod L 350mm)

C30240 (Asta/Rod L 400mm)

BAROCCO ITALIANO
ITALIAN BAROQUE



C32000

**Asta C319AS non inclusa
nella confezione**

Rod C319AS is not
included in the package



C30400

25 (Asta/Rod L 250 mm)

30 (Asta/Rod L 300 mm)

35 (Asta/Rod L 350 mm)

40 (Asta/Rod L 400 mm)

LUIGI XV
LOUIS XV



CARIGLIONI E CATENACCI

CREMONE BOLTS AND SLIDING BOLTS



C30100
25 (Asta/Rod L 250 mm)
30 (Asta/Rod L 300 mm)
35 (Asta/Rod L 350 mm)
40 (Asta/Rod L 400 mm)



C32900
**Asta C319AS non inclusa
nella confezione**
Rod C319AS is not
included in the package

PRIMO IMPERO
FIRST EMPIRE

C32901
**Asta C319AS non inclusa
nella confezione**
Rod C319AS is not
included in the package

PRIMO IMPERO
FIRST EMPIRE

CARIGLIONI E CATENACCI

CREMONE BOLTS AND SLIDING BOLTS



C30300
25 (Asta/Rod L 250mm)
30 (Asta/Rod L 300mm)
35 (Asta/Rod L 350mm)
40 (Asta/Rod L 400mm)



C35900
**Asta C319AS non inclusa
nella confezione**
Rod C319AS is not
included in the package

SECONDO IMPERO
SECOND EMPIRE

C35901
**Asta C319AS non inclusa
nella confezione**
Rod C319AS is not
included in the package

SECONDO IMPERO
SECOND EMPIRE

CARIGLIONI E CATENACCI

CREMONE BOLTS AND SLIDING BOLTS



C35902
**Asta C319AS non inclusa
nella confezione**
Rod C319AS is not
included in the package

SECONDO IMPERO
SECOND EMPIRE

C32100
**Asta C319AS non inclusa
nella confezione**
Rod C319AS is not
included in the package



C30500
25 (Asta/Rod L 250 mm)
30 (Asta/Rod L 300 mm)
35 (Asta/Rod L 350 mm)
40 (Asta/Rod L 400 mm)

NOVECENTO
XX CENTURY

CARIGLIONI E CATENACCI
CREMONE BOLTS AND SLIDING BOLTS



C32200
**Asta C319AS non inclusa
nella confezione**
Rod C319AS is not
included in the package

TRENTA
THIRTIES



C32300
**Asta C319AS non inclusa
nella confezione**
Rod C319AS is not
included in the package

TRENTA
THIRTIES

ALZANTI SCORREVOLI
TILT AND SLIDE PATIO HANDLES



C13070
44x242

NOVECENTO
XX CENTURY



C17370
44x265

NOVECENTO
XX CENTURY



C15170
44x267

NOVECENTO
XX CENTURY



C10170
50x229

NOVECENTO
XX CENTURY

ALZANTI SCORREVOLI
TILT AND SLIDE PATIO HANDLES



C02970
44x280

TRENTA
THIRTIES



C05470
44x228

TRENTA
THIRTIES



C02470
44x256

TRENTA
THIRTIES

ALZANTI SCORREVOLI
TILT AND SLIDE PATIO HANDLES



C08270
44x229

TRENTA
THIRTIES



C09270
44x229

TRENTA
THIRTIES



C06870
44x256

CINQUANTA
FIFTIES



C07970
44x256

CINQUANTA
FIFTIES

PLACCHE PORTANOME
NAME AND NUMBER PLATES



C64200
160x91

BAROCCO ITALIANO
ITALIAN BAROQUE



C64300
134x58

BAROCCO ITALIANO
ITALIAN BAROQUE



C64100
166x121

LUIGI XV
LOUIS XV



C64400
160x34

IMPERO
EMPIRE



LE NOSTRE LAVORAZIONI

OUR PROCESSES



**STAMPAGGIO
A CALDO**

**HOT
FORGING**

La tecnologia dello stampaggio a caldo ha preso il posto della tradizionale fusione in quanto consente di ottenere Prodotti di qualità nettamente superiore ed una qualità costante del prodotto.

Le nostre macchine per lo stampaggio a caldo sono le più innovative e performanti disponibili sul mercato ed i nostri Tecnici sono in grado di ottimizzare al massimo il processo produttivo mantenendo il livello di qualità che contraddistingue le Officine Meccaniche Porro.

Hot forging technology has replaced the traditional metal casting process, since it allows producing more consistent and higher quality objects.

Our hot forging equipment is among the most innovative and efficient available on the market, and our technicians are able to optimize the production process, while preserving Officine Meccaniche Porro's renowned level of quality.



**PVD
(PHYSICAL VAPOUR
DEPOSITION)**

**PVD
(PHYSICAL VAPOUR
DEPOSITION)**

Ovvero il processo di deposizione molecolare in condizioni di alto vuoto e ad alte temperature che consentono ai nostri prodotti di avere un'elevatissima resistenza agli agenti chimici e atmosferici, illimitata resistenza all'ossidazione e un potenziamento di 4 volte della resistenza antigraffio rispetto ai normali rivestimenti galvanici.

PVD, or molecular deposition process in high vacuum conditions and at high temperatures, gives our products extreme resistance to chemical agents and meteorological elements, as well as unlimited resistance to oxidation and scratch-proof properties that are 4 times greater than those achieved by standard galvanized coatings.



BOCCIARDATURA

**BUSH
HAMMERING**

Una speciale macchina consente di bocciardare ovvero rendere corrugata - ma sempre piacevole al tatto - la superficie in ottone pieno.

Questa lavorazione richiede un ritocco manuale al fine di ottenere un manufatto senza sbavature quindi assolutamente perfetto.

A special machine allows to bush-hammer, or corrugate, a full brass surface, making it pleasant to the touch. This process requires manual touch-ups in order to eliminate possible smearing and thus obtain a perfect finished product.

FUSIONE A CERA PERSA

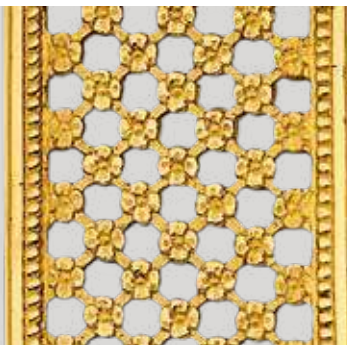

LOST WAX CASTING PROCESS

Un modello in cera viene creato da un Mastro Cesellatore che poi lo riveste accuratamente di polvere ceramica per passarlo in forno a 1200°C.

La cera si fonde (cera persa) e, dell'oggetto, resta un calco in ceramica che fungerà da stampo per la fusione consentendoci di ottenere oggetti in metallo nobile con forme estremamente complesse e dettagli molto accurati.

A wax model is created by a Master Chiseller, who covers it thoroughly in ceramic powder and places it in an oven, at 1200°C.

The wax then melts away (lost wax) and the remaining ceramic cast will serve as a mold for the creation of noble metal objects featuring extremely complex shapes and very accurate details.

CESELLATURA



CHISELLING

Nonostante l'uso di stampi, siano essi gli storici o i più moderni delle collezioni contemporanee, alcuni particolari decorativi richiedono ancora la mano esperta del Mastro Cesellatore che va a rifinire e portare al dovuto risalto i particolari più minuti ottenendo un vero e proprio «pezzo d'arte» unico e immediatamente distinguibile.

Despite the use of molds, whether from historical or more contemporary collections, some decorative details still require the expert hand of the Master Chiseller, who refines and enhances the smallest details, thus producing a true, unique and immediately recognizable "art piece".

LAVORAZIONE ARTIGIANALE



CRAFTSMANSHIP

Tutte le nostre lavorazioni artigianali sono rese possibili dalla struttura produttiva della nostra Azienda che, pur consentendo una notevole rapidità di produzione, è strutturata per piccoli reparti che lavorano in sinergia tra loro.

Vere e proprie botteghe artigiane con il proprio Maestro che, con passione e attenzione, segue il lavoro del proprio gruppo trasmettendo le conoscenze e le tecniche più adatte ad ogni singola lavorazione.

All our creations are made possible by the production structure of our company that, while allowing for considerable speed of production, comprises small departments working in synergy with each other.

True artisan shops, each led by their Master with passion and attention.

Masters carefully oversee the work of their team, sharing the knowledge and techniques best suited to each task.



DIAMANTATURA

DIAMOND DRESSING

Con questo processo di finitura riusciamo a far «brillare» i nostri prodotti come un gioiello prezioso.

La lavorazione consente di ottenere purezza geometrica, planarità delle superfici e un'estrema luminosità; e, quindi si ottiene con l'utilizzo di un diamante naturale, considerato il minerale più duro ed abrasivo in natura.

Diamond dressing allows us to make our products shine like precious jewels.

The manufacturing process allows obtaining geometric purity, flat surfaces and extreme brightness. Diamond dressing is carried out by the use of a natural diamond, the hardest and most abrasive mineral in nature.



CUSCINETTO

BALL BEARING

Per le nostre maniglie abbiamo brevettato un innovativo cuscinetto a sfere in acciaio inox con fermo molla integrato e di uno spessore di soli 5 mm.

Grazie a questo nostro brevetto l'attrito meccanico viene eliminato consentendo una durata nel tempo ineguagliabile.

For our handles, we have patented an innovative stainless steel ball bearing with integrated spring stopper and a thickness of only 5 mm.

As a result, mechanical friction is totally eliminated, thus ensuring unmatched durability over time.



MANIGLIE D'ARTE

Uniche sul mercato per la cura e la realizzazione nel rispetto di precisi canoni estetici.

ASSORTIMENTO

Una collezione di maniglie che ripropone, con estrema cura dei particolari, maniglie di tutte le epoche dal 1630 ad oggi.

FINITURE

Le nostre maniglie vengono ancora rifinite manualmente con la cura e la passione artigianale che contraddistinguono l'Eccellenza Italiana.

MATERIE PRIME

Per le nostre maniglie - come per tutta la nostra produzione - vengono impiegate solo materie prime di elevata qualità.

MISURE

Le misure sono espresse in millimetri. Le misure degli articoli indicate nel catalogo possono subire lievi modifiche di perfezionamento.

100% MADE IN ITALY

Tutti i prodotti Enrico Cassina, come tutta la produzione Officine Meccaniche Porro, sono garantiti come interamente concepiti e realizzati in Italia.

ARTISTIC HANDLES

Unique on the market for the great attention to detail in compliance with particular aesthetic canons.

RICH INVENTORY

A collection of handles that, with great attention to detail, reproduce handles of all art periods, stretching from 1630 to today.

FINISHES

Our handles are decorated by hand with the great care and craftsmanship that embody Italian Excellence.

RAW MATERIALS

For our handles, as well as for the rest of our production, we only use high-quality raw materials.

MEASUREMENTS

All dimensions are in millimeters. Item's dimensions indicated in the price list could vary slightly according to the finished products' requirements.

100% MADE IN ITALY

Like the entire Officine Meccaniche Porro catalog, all Alfredo Porro accessories have been entirely designed and manufactured in Italy.



FINITURE A LISTINO

PRICE LIST FINISHING



Oro Non Verniciato
Polished Brass Not Lacquered



Oro Lucido
Polished Brass



Oro PVD
Polished Brass PVD



Bagno Oro
Gold Plated



Bagno Oro PVD
Gold PVD



Oro Antico PVD
Old Gold PVD



Oro Imperiale
Imperial Gold



Oro Antico
Old Gold



Bronzo Antico
Antique Bronze



Bronzo Opaco
Matt Bronze



Ottone Antico
Ancient Brass



Nero Opaco
Matt Black



Nickel Lucido
Nickel Plated



Nickel Satinato
Satin Nickel



Cromo Lucido
Chrome Plated



Cromo Satinato
Satin Chrome

FINITURE SPECIALI

SPECIAL FINISHING



Oro Satinato
Satin Brass



Patined Steel



Oil Rubbed Bronze

INEDITA



Oro Lucido

Polished Brass



Oro Satinato Opaco

Matt Satin Brass



Cromo Lucido

Chrome Plated



Cromo Satinato

Satin Chrome



Nero Opaco

Matt Black

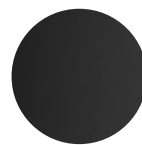

Nero Lucido

Bright Black

Only for door handle AMAL



Powder Blue

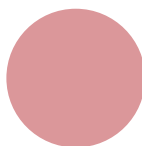

Antique Pink



Sand



Sage Green



Apple Green

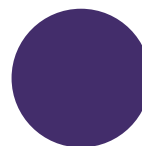

Indigo

Only for door handles GALA and DODO

COLLEZIONE ZIGRINATA THE KNURLED COLLECTION



Oro Lucido

Polished Brass



Oro Satinato Opaco

Matt Satin Brass



Bronzo Opaco

Matt Bronze



Nero Opaco

Matt Black



Nickel Lucido

Nickel Plated



Nickel Satinato

Satin Nickel



Cromo Lucido

Chrome Plated



Cromo Satinato

Satin Chrome

ROCOCÒPOP



Pop Red



Pop Yellow



Pop Blue



Pop Purple



Pop Black



Pop White



Pop Matt Green



Pop Matt Blue



Pop Matt Black



Pop Matt White

ÉLITE

FINITURE A LISTINO

PRICE LIST FINISHING



Oro Non Verniciato
Polished Brass
Not Lacquered



Oro Lucido
Polished Brass



Bagno Oro
Gold Plated



Bronzo Opaco
Matt Bronze



Ottone Antico
Ancient Brass

FINITURE SPECIALI

SPECIAL FINISHING



Oil Rubbed Bronze

I COLORI DELLE FINITURE SONO INDICATIVI

Alcune finiture vengono eseguite manualmente e pertanto possono presentare variazioni di tonalità e sfumatura creando doti di unicità e bellezza del prodotto.

THE COLOURS OF THE FINISHES ARE INDICATIVE

Some of the finishes are performed manually therefore variations in colour tone and shading may occur giving beauty and uniqueness to the product.

Credits

Progetto grafico / Graphic design
Adf&R S.r.l. Milano

Impaginazione / Layout
Adf&R S.r.l. Milano
OMP PORRO S.r.l.

Stampa / Printing
Arti Grafiche Meroni S.r.l.

Foto / Pictures
- I.K.B.
- Mimmo Capurso

ENRICO CASSINA

MANUFACTURED BY OFFICINE MECCANICHE PORRO

omporro 
officine meccaniche porro

OMP PORRO S.r.l

22060 Cucciago (CO) ITALY - via Stazione, 8/a
tel. +39 031.787100 r.a. - fax +39 031.787575

info@omporro.eu
enricocassina.it